

## Evacuation Dynamics: Empirical Results, Modeling and Applications

ANDREAS SCHADSCHNEIDER<sup>1,2</sup>, WOLFRAM KLINGSCH<sup>3</sup>,  
HUBERT KLÜPFEL<sup>4</sup>, TOBIAS KRETZ<sup>5</sup>,

CHRISTIAN ROGSCHE<sup>3</sup>, ARMIN SEYFRIED<sup>6</sup>

<sup>1</sup> Institut für Theoretische Physik, Universität zu Köln,  
Köln, Germany

<sup>2</sup> Interdisziplinäres Zentrum für Komplexe Systeme,  
Bonn, Germany

<sup>3</sup> Institute for Building Material Technology  
and Fire Safety Science, University of Wuppertal,  
Wuppertal, Germany

<sup>4</sup> TraffGo HT GmbH, Duisburg, Germany

<sup>5</sup> PTV Planung Transport Verkehr AG, Karlsruhe,  
Germany

<sup>6</sup> Jülich Supercomputing Centre, Research Centre Jülich,  
Jülich, Germany

### Article Outline

[Glossary](#)

[Definition of the Subject](#)

[Introduction](#)

[Empirical Results](#)

[Modeling](#)

[Applications](#)

[Future Directions](#)

[Acknowledgments](#)

[Bibliography](#)

### Glossary

**Pedestrian** A person traveling on foot. In this article, other characterizations are used depending on the context, e. g., agent or particle.

**Crowd** A large group of pedestrians moving in the same area, but not necessarily in the same direction.

**Evacuation** The movement of persons from a dangerous place due to the threat or occurrence of a disastrous event. In normal situations this is called “egress” instead.

**Flow** The flow or current  $J$  is defined as the number of persons passing a specified cross-section per unit time. The common unit of flow is “persons per second”. Specific flow is the flow per unit cross-section. The maximal flow supported by a facility (or a part of it) is called “capacity”.

**Fundamental diagram** In traffic engineering (and physics): density-dependence of the flow:  $J(\rho)$ . Due to the hydrodynamic relation  $J = \rho v b$  equivalent rep-

resentations used frequently are  $v = v(\rho)$  or  $v = v(J)$ . The fundamental diagram is probably the most important quantitative characterization of traffic systems.

**Lane formation** In bidirectional flows, lanes are often dynamically formed in which all pedestrians move in the same direction.

**Bottleneck** A limited resource for pedestrian flows, for example a door, a narrowing in a corridor, or stairs, i. e., a location of reduced capacity. At bottlenecks jamming occurs if the inflow is larger than the capacity. Other phenomena that can be observed are the formation of lanes and the zipper-effect.

**Microscopic models** Models which represent each pedestrian separately with individual properties like walking velocity or route choice behavior and the interactions between them. Typical models that belong to this class are cellular automata and the social-force model.

**Macroscopic models** Models which do not distinguish individuals. The description is based on aggregate quantities, e. g., appropriate densities. Typical models belonging to this class are fluid-dynamic approaches. Hand calculation methods which are based on related ideas and are often used in the field of (fire-safety) engineering belong to this class as well.

**Crowd disaster** An accident in which the specific behavior of the crowd is a relevant factor, e. g., through competitive and non-adaptive behavior. In the media, it is often called “panic” which is a controversial concept in crowd dynamics and should thus be avoided.

### Definition of the Subject

Today, there are many occasions on which a large number of people gathers in a rather small area. Office buildings and apartment houses grow larger and more complex. Very large events related to sports, entertainment or cultural and religious events are held all over the world on a regular basis. This brings about serious safety issues for the participants and for the organizers who must be prepared for any case of emergency or critical situation. Usually in such cases the participants must be guided away from the dangerous area as quickly as possible. Therefore the understanding of the dynamics of large groups of people is very important.

In general, evacuation is egress from an area, a building or a vessel due to a potential or actual threat. In the cases described above, the dynamics of the evacuation processes are quite complex due to the large number of people and their interaction, external factors such as fire, complex building geometries, etc. Evacuation dynamics must be described and understood on different levels: physical,

physiological, psychological, and social. Accordingly, the scientific investigation of evacuation dynamics involves many research areas and disciplines. The system “evacuation process” (i. e., the population and the environment) can be modeled on many different levels of detail, ranging from hydro-dynamic models to artificial intelligence and multi-agent systems. There are at least three aspects of evacuation dynamics that motivate its scientific investigation:

- 1) As in most many-particle systems several interesting collective phenomena can be observed that need to be explained;
- 2) Models need to be developed that are able to reproduce pedestrian dynamics in a realistic way, and
- 3) Pedestrian dynamics must be applied to facility design and to emergency preparation and management.

The investigation of evacuation dynamics is a difficult problem that requires close collaboration between different fields. The origin of the apparent complexity lies in the fact that one is concerned with a many-‘particle’ system with complex interactions that are not fully understood. Typically the systems are far from equilibrium and so are, e. g., sensitive to boundary conditions. Motion and behavior are influenced by several external factors and often crowds can be rather inhomogeneous.

In this article we want to deal with these problems from different perspectives and will not only review the theoretical background, but will also discuss some concrete applications.

## Introduction

The awareness that emergency exits are one of the most important factors to ensure the safety of persons in buildings can be traced back more than 100 years. Disasters due to the fires in the Ring theater in Vienna and the urban theater in Nizza in 1881 resulted in several hundred fatalities and led to a rethinking of the safety in buildings [24]. First, attempts were made to improve safety by using non-flammable building materials. However, the disaster at the Troquois Theater in Chicago with more than 500 fatalities, where only the decorations burned, demonstrated the need for more effective measures. This was a starting point for studying the influences of emergency exits and thus the dynamics of pedestrian streams [24,32].

In recent years there have been two major evacuation incidents which gained immense global attention. First, there was the capsizing of the Baltic Sea ferry MV Estonia (September 28, 1994, 852 casualties) [100] and, of course, the terrorist attacks of 9/11 (2,749 casualties).

Other prominent examples of the possible tragic outcomes of the dynamics of pedestrian crowds are the Hillsborough stadium disaster in Sheffield (April 15, 1989, 96 casualties) [182], the accident at Bergisel (December 4, 1999, 5 casualties) [189], the stampede in Baghdad (August 30, 2005, 1,011 casualties), the tragedy at the concert of “The Who” (December 3, 1979, 11 casualties) [73] and – very early – the events at the crowning ceremony of Tsar Nicholas II in St. Petersburg in May 1896 with 1,300 to 3,000 fatalities (sources vary considerably) [168]. In the past, tragic accidents have happened frequently in Mecca during the Hajj (1990: 1,426, 1994: 270, 1997: 343, 1998: 107, 2001: 35, 2003: 14, 2004: 244, and 2006: 364 casualties). What stands out is that the initiating events are very diverse and range from external human aggression (terrorism) to external physical dangers (fire) and rumors to various shades of greedy behavior in absence of any external danger.

Many authors have pointed out that the results of experts’ investigations and the way the media typically reports about an accident very often differ strongly [17,77,109,155,156,178]. Public discussion has a much greater tendency to identify “panic” as the cause of a disaster, while expert commissions often conclude that there either was no panic at all, or panic was merely a result of some other preceding phenomenon.

This article first discusses the empirical basis of pedestrian dynamics in Sect. “Empirical Results”. Here we introduce the basic observables and describe the main qualitative and quantitative results, focusing on collective phenomena and the fundamental diagram. It is emphasized that even for the most basic quantities, no consensus about basic behavior has been reached.

In Sect. “Modeling” various model approaches that have been applied to the description of pedestrian dynamics are reviewed.

Section “Applications” discusses more practical issues and gives a few examples for applications to safety analysis. In this regard, prediction of evacuation times is an important problem as legal regulations must often be fulfilled. Here, commercial software tools are available. A comparison shows that the results must be interpreted with care.

## Empirical Results

### Overview

Pedestrians are three-dimensional objects and a complete description of their highly developed and complicated motion sequence is rather difficult. Therefore, in pedestrian and evacuation dynamics, pedestrian motion is usu-

ally treated as two-dimensional by considering the vertical projection of the body.

In the following sections we review the present knowledge of empirical results. These are relevant not only as a basis for the development of models, but also for applications such as safety studies and legal regulations.

We start with the phenomenological description of collective effects. Some of these are known from everyday experience and will serve as benchmark tests for any kind of modeling approach. Any model that does not reproduce these effects is missing some essential part of the dynamics. Next, the foundations of a quantitative description are laid by introducing the fundamental observables of pedestrian dynamics. Difficulties arise from different conventions and definitions. Then pedestrian dynamics in several simple scenarios (corridor, stairs etc.) are discussed. Surprisingly, even for these simple cases no consensus about the basic quantitative properties exists. Finally, more complex scenarios are discussed which are combinations of the simpler elements. Investigations of scenarios such as evacuations of large buildings or ships suffer even more from lack of reliable quantitative and sometimes even qualitative results.

### Collective Effects

One of the reasons why the investigation of pedestrian dynamics is attractive for physicists is the large variety of interesting collective effects and self-organization phenomena that can be observed. These macroscopic effects reflect the individuals' microscopic interactions and thus give important information for any modeling approach.

**Jamming** Jamming and clogging typically occur for high densities at locations where the inflow exceeds capacity. Locations with reduced capacity are called *bottlenecks*. Typical examples are exits (Fig. 1) or narrowings. This kind of jamming phenomenon does not depend strongly on the microscopic dynamics of the particles. Rather it is a consequence of an exclusion principle: space occupied by one particle is not available for others.

This clogging effect is typical for a bottleneck situation. It is important for practical applications, especially evacuation simulations.

Other types of jamming occur in the case of counterflow where two groups of pedestrians mutually block each other. This happens typically at high densities and when it is not possible to turn around and move back, e. g., when the flow of people is large.

**Density waves** Density waves in pedestrian crowds can be generally characterized as quasi-periodic density varia-



Evacuation Dynamics: Empirical Results, Modeling and Applications, Figure 1  
Clogging near a bottleneck. The shape of the clog is discussed in more detail in Subsect. "Theoretical Results"

tions in space and time. A typical example is the movement in a densely crowded corridor (e. g., in subway-stations close to the density that causes a complete halt of motion) where phenomena similar to stop-and-go vehicular traffic can be observed, e. g., density fluctuations in a longitudinal direction that move backwards (opposite to the movement direction of the crowd) through the corridor. More specifically, for the situation on the Jamarat Bridge in Makkah (during the Hajj pilgrimage 2006), stop-and-go waves have been reported. At densities of 7 persons per  $m^2$  upstream, moving stop-and-go waves of period 45 s have been observed that lasted for 20 minutes [59]. Fruin reports, that "at occupancies of about 7 persons per square meter the crowd becomes almost a fluid mass. Shock waves can be propagated through the mass sufficient to lift people off their feet and propel them distances of 3 m (10 ft) or more." [36].

**Lane formation** In counterflow, i. e., two groups of people moving in opposite directions, (dynamically varying) lanes are formed where people move in just one direction [135,139,197]. In this way, strong in-

interactions with oncoming pedestrians are reduced which is more comfortable and allows higher walking speeds.

The occurrence of lane formation does not require a preference of moving on one side. It also occurs in situations without left- or right-preference. However, cultural differences for the preferred side have been observed. Although this preference is not essential for the phenomenon itself, it has an influence on the kind of lanes formed and their order.

Several quantities for the quantitative characterization of lane formation have been proposed. Yamori [197] has introduced a band index which is basically the ratio of pedestrians in lanes to their total number. In [13] a characterization of lane formation through the (transversal) velocity profiles at fixed positions has been proposed. Lane formation has also been predicted to occur in colloidal mixtures driven by an external field [15,28,158]. Here, an order parameter  $\phi = \frac{1}{N} \langle \sum_{j=1}^N \phi_j \rangle$  has been introduced where  $\phi_j = 1$  if the lateral distance to all other particles of the other type is larger than a typical density-dependent length scale, and  $\phi_j = 0$  otherwise.

The number of lanes can vary considerably with the total width of the flow. Figure 2 shows a street in the city center of Cologne during World Youth Day in Cologne (August 2005) where two comparatively large lanes have been formed.

The number of lanes usually is not constant and might change in time, even if there are relatively small changes in density. The number of lanes in opposite di-

rections is not always identical. This can be interpreted as a sort of spontaneous symmetry breaking.

Quantitative empirical studies of lane formation are rare. Experimental results have been reported in [94] where two groups with varying relative sizes had to pass each other in a corridor with a width of 2 m. On one hand, similar to [197] a variety of different lane patterns were observed, ranging from 2 to 4 lanes. On the other hand, in spite of this complexity, surprisingly large flows could be measured: the sum of (specific) flow and counterflow was between 1.8 and 2.8 persons per meter per second and exceeded the specific flow for one-directional motion ( $\approx 1.4$  P/ms).

**Oscillations** In counterflow at bottlenecks, e. g., doors, one can sometimes observe oscillatory changes of the direction of motion. Once a pedestrian is able to pass the bottleneck it becomes easier for others to follow in the same direction until somebody is able to pass the bottleneck (e. g., through a fluctuation) in the opposite direction.

**Patterns at intersections** At intersections, various collective patterns of motion can be formed. A typical example is short-lived roundabouts which make motion more efficient. Even if these are connected with small detours, the formation of these patterns can be favorable since they allow for “smoother” motion.

**Emergency situations, “panic”** In emergency situations various collective phenomena have been reported that have sometimes misleadingly been attributed to *panic behavior*. However, there is strong evidence that this is not the case. Although a precise accepted definition of *panic* is missing, usually certain aspects are associated with this concept [77]. Typically “panic” is assumed to occur in situations where people compete for scarce or dwindling resources (e. g., safe space or access to an exit) which leads to selfish, asocial or even completely irrational behavior and contagion that affects large groups. A closer investigation of many crowd disasters has revealed that most of the above characteristics have played almost no role and most of the time have not been observed at all (see e. g. [73]). Often the reason for these accidents is much simpler, e. g., in several cases the capacity of the facilities was too small for the actual pedestrian traffic, e. g., Luschniki Stadium Moskau (October 20, 1982), Bergisel (December 4, 1999), pedestrian bridge Kobe (Akashi) (July 21, 2001) [186]. Therefore the term “panic” should be avoided, *crowd disaster* being a more appropriate characterization. Also it should be kept in mind that in dangerous situations it is *not* irrational to fight for resources (or for your own life), if everybody else does



Evacuation Dynamics: Empirical Results, Modeling and Applications, Figure 2

The “Hohe Straße” in Cologne during World Youth Day 2005. The yellow line is the border of the two walking directions

this [18,113]. Only from the outside is this behavior perceived as irrational since it might lead to a catastrophe [178]. The latter aspect is therefore better described as *non-adaptive behavior*. We will discuss these issues in more detail in Subsect. “**Evacuations: Empirical Results**”.

## Observables

Before we review experimental studies in this section, the commonly used observables are introduced.

The flow  $J$  of a pedestrian stream gives the number of pedestrians crossing a fixed location of a facility per unit of time. Usually it is taken as a scalar quantity since only the flow normal to some cross-section is considered. There are various methods to measure flow. The most natural approach is to determine the times  $t_i$  at which pedestrians pass a fixed measurement location. The time gaps  $\Delta t_i = t_{i+1} - t_i$  between two consecutive pedestrians  $i$  and  $i + 1$  are directly related to the flow

$$J = \frac{1}{\langle \Delta t_i \rangle} \quad \text{with} \quad \langle \Delta t_i \rangle = \frac{1}{N} \sum_{i=1}^N (t_{i+1} - t_i) = \frac{t_{N+1} - t_1}{N}. \quad (1)$$

Another possibility for measuring the flow of a pedestrian stream is borrowed from fluid dynamics. The flow through a facility of width  $b$  is determined by the average density  $\rho$  and the average speed  $v$  of a pedestrian stream as

$$J = \rho v b = J_s b. \quad (2)$$

where the *specific flow*<sup>1</sup>

$$J_s = \rho v \quad (3)$$

gives the flow per unit-width. This relation is also known as *hydrodynamic relation*.

There are several problems concerning the way in which velocities, densities or time gaps are measured and the conformance of the two definitions of flow. The flow according to Eq. (1) is usually measured as a mean value over time at a certain location, while the measurement of the density in Eq. (2) is connected with an instantaneous mean value over space. This can lead to a bias caused by underestimation of fast moving pedestrians at the average over space compared to the mean value of the flow over time at a single measurement line (see the discussion for vehicular traffic e. g., in [51,81,102]). Furthermore,

<sup>1</sup>In strictly one-dimensional motion often a line density (dimension: 1/length) is used. Then the flow is given by  $J = \rho v$ .

most experimental studies measuring the flow according to Eq. (2) combine for technical reasons an *average* velocity of a single pedestrian over time with an *instantaneous* density. To ensure a correspondence of the mean values the average velocity of all pedestrians contributing to the density at a certain instant has to be considered. However this procedure is very time consuming and not realized in practice up to now. Moreover, the fact that the dimension of the test section has usually the same order of magnitude as the extent of the pedestrians can influence the averages over space. These all are possible factors why different measurements can differ in a large way, see discussion in Subsect. “**Fundamental Diagram**”.

Another way to quantify the pedestrian load of facilities has been proposed by Fruin [35]. The “pedestrian area module” is given by the reciprocal of the density. Thompson and Marchant [184] introduced the so-called “inter-person distance”  $d$ , which is measured between center coordinates of the assessing and obstructing persons. According to the “pedestrian area module” Thompson and Marchant call  $\sqrt{1/\rho}$  the “average inter-person distance” for a pedestrian stream of evenly spaced persons [184]. An alternative definition is introduced in [58] where the local density is obtained by averaging over a circular region of radius  $R$ ,

$$\rho(\mathbf{r}, t) = \sum_j f(\mathbf{r}_j(t) - \mathbf{r}), \quad (4)$$

where  $\mathbf{r}_j(t)$  are the positions of the pedestrians  $j$  encompassed by  $\mathbf{r}$  and  $f(\dots)$  is a Gaussian, distance-dependent weight function.

In contrast to the density definitions above, Predtechenskii and Milinskii [151] consider the ratio of the sum of the projection area  $f_j$  of the bodies and the total area of the pedestrian stream  $A$ , defining the (dimensionless) density  $\tilde{\rho}$  as

$$\tilde{\rho} = \frac{\sum_j f_j}{A}, \quad (5)$$

a quantity known as *occupancy* in the context of vehicular traffic. Since the projection area  $f_j$  depends strongly on the type of person (e. g., it is much smaller for a child than for an adult), the densities for different pedestrian streams consisting of the same number of persons and the same stream area can be quite different.

Beside technical problems due to camera distortions and camera perspective there are several conceptual problems, such as the association of averaged with instantaneous quantities, the need to choose an observation area in the same order of magnitude as the extent of a pedestrian together with the definition of the density of objects

with nonzero extent and much more. A detailed analysis of the ways in which measurement influences the relations is necessary but still lacking.

### Fundamental Diagram

The fundamental diagram describes the empirical relation between density  $\rho$  and flow  $J$ . The name indicates its importance and naturally it has been the subject of many investigations. Due to the hydrodynamic relation (3) there are three equivalent forms:  $J_s(\rho)$ ,  $v(\rho)$  and  $v(J_s)$ . In applications the relation is a basic input for engineering methods developed for the design and dimensioning of pedestrian facilities [35,136,150]. Furthermore, it is a quantitative benchmark for models of pedestrian dynamics [21,86,112,175].

In this section we will concentrate on planar facilities such as sidewalks, corridors and halls. For various facilities such as floors, stairs or ramps, the shape of the diagrams differ, but in general it is assumed that the fundamental diagrams for the same type of facilities but having different widths merge into one diagram for the specific flow  $J_s$ . In first order this is confirmed by measurements on different widths [49,135,139,142]. However, Navin and Wheeler observed in narrow sidewalks more orderly movement leading to slightly higher specific flows than for wider sidewalks [135]. A natural lower bound for the independence of the specific flow from the width is given by the body size and the asymmetry in movement possibilities of the hu-

man body. Surprisingly, Kretz et al. found an increase of the specific flow for bottlenecks with  $b \leq 0.7$  m [93]. This will be discussed in more detail later. For the following discussion we assume facility widths larger than  $b = 0.6$  m and use the most common representations  $J_s(\rho)$  and  $v(\rho)$ .

Figure 3 shows various fundamental diagrams used in planning guidelines and measurements of two selected empirical studies representing the overall range of the data. The comparison reveals that specifications and measurements disagree considerably. In particular, the maximum of the function giving the capacity  $J_{s,\max}$  ranges from  $1.2$  (ms)<sup>-1</sup> to  $1.8$  (ms)<sup>-1</sup>, the density value where the maximum flow is reached ( $\rho_c$ ) ranges from  $1.75$  m<sup>-2</sup> to  $7$  m<sup>-2</sup> and, most notably, the density  $\rho_0$ , where the velocity approaches zero due to overcrowding, ranges from  $3.8$  m<sup>-2</sup> to  $10$  m<sup>-2</sup>.

Several explanations for these deviations have been suggested, including cultural and population differences [58,116], differences between uni- and multidirectional flow [99,135,154], short-ranged fluctuations [154], influence of psychological factors given by the incentive of the movement [150] and, partially related to the latter, the type of traffic (commuters, shoppers) [139].

It seems that the most elaborate fundamental diagram is given by Weidmann who collected 25 data sets. An examination of the data which were included in Weidmann's analysis shows that most measurements with densities larger than  $\rho = 1.8$  m<sup>-2</sup> are performed on multidirectional streams [135,139,140,142,148]. But data gained

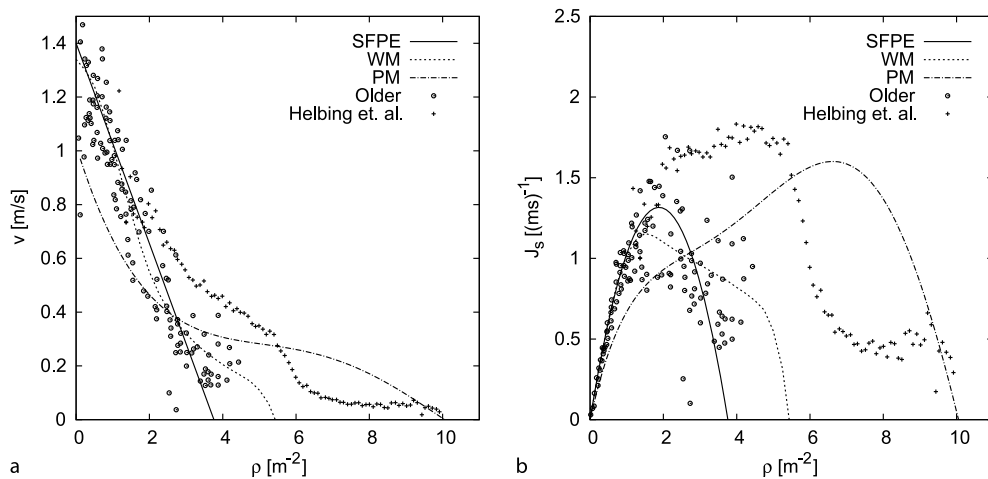

Evacuation Dynamics: Empirical Results, Modeling and Applications, Figure 3

Fundamental diagrams for pedestrian movement in planar facilities. The lines refer to specifications according to planning guidelines (SFPE Handbook [136]), Predtechenskii and Milinskii (PM) [150], Weidmann (WM) [192]). Data points give the range of experimental measurements (Older [142] and Helbing [58])

by measurements on strictly unidirectional streams has also been considered [35,49,188]. Thus Weidmann neglected differences between uni- and multidirectional flow in accordance with Fruin, who states in his often cited book [35] that the fundamental diagrams of multidirectional and unidirectional flow differ only slightly. This disagrees with results of Navin and Wheeler [135] and Lam et al. [99] who found a reduction of the flow in dependence of directional imbalances. Here lane formation in bidirectional flow has to be considered. Bidirectional pedestrian flow includes unordered streams as well as lane-separated and thus quasi-unidirectional streams in opposite directions. A more detailed discussion and data can be found in [99,135,154]. A surprising finding is that the sum of flow and counterflow in corridors is larger than the unidirectional flow and for equally distributed loads it can be twice the unidirectional flow [94].

Another explanation is given by Helbing et al. [58] who argue that cultural and population differences are responsible for the deviations between Weidmann and their data. In contrast to this interpretation the data of Hanking and Wright [49] gained by measurements in the London subway (UK) are in good agreement with the data of Mori and Tsukaguchi [115] measured in the central business district of Osaka (Japan), both on strictly uni-directional streams. This brief discussion clearly shows that up to now there is no consensus about the origin of the discrepancies between different fundamental diagrams and how one can explain the shape of the function.

However, all diagrams agree in one characteristic: velocity decreases with increasing density. As the discussion above indicates there are many possible reasons and causes for the velocity reduction. For the movement of pedestrians along a line, a linear relation between speed and the inverse of the density was measured in [174]. The speed for walking pedestrians depends also linearly on the step size [192] and the inverse of the density can be regarded as the required length for one pedestrian to move. Thus it seems that smaller step sizes caused by a reduction of the available space with increasing density is, at least for a certain density region, one cause for the decrease of speed. However, this is only a starting point for a more elaborated modeling of the fundamental diagram.

### Bottleneck Flow

The flow of pedestrians through bottlenecks shows a rich variety of phenomena, e. g., the formation of lanes at the entrance to the bottleneck [64,66,93,176], clogging and blockages at narrow bottlenecks [24,57,93,121,122,150] or some special features of bidirectional bottleneck flow [57].

Moreover, the estimation of bottleneck capacities by the maxima of fundamental diagrams is an important tool for the design and dimensioning of pedestrian facilities.

**Capacity and Bottleneck Width** One of the most important practical questions is how the capacity of a bottleneck rises with increasing width. Studies of this dependence can be traced back to the beginning of the last century [24,32] and, up to now, have been discussed controversially. As already mentioned in the context of the fundamental diagram there are multiple possible influences on pedestrian flow and thus on the capacity. In the following, the major findings are outlined, demonstrating the complexity of the system and documenting a controversial discussion over one hundred years.

At first sight, a stepwise increase of capacity with the width appears to be natural if lanes are formed. For independent lanes, where pedestrians in one lane are not influenced by those in others, the capacity increases only if an additional lane can be formed. This is reflected in the stepwise enlargement of exit width, which has been a requirement of several building codes and design recommendations. See e. g., the discussion in [146] for the USA and GB and [130] for Germany. e. g.; the German building code requires an exit width (e. g., for a door) to be at least 90 cm plus 60 cm for every 200 persons. Independently from this simple lane model, Hoogendoorn and Daamen [64,66] measured by a laboratory experiment the trajectories of pedestrians passing a bottleneck. The trajectories show that inside a bottleneck the formation of lanes occurs, resulting from the zipper effect occurring on entry to the bottleneck. Due to the zipper effect, a self-organization phenomenon leading to an optimization of the available space and velocity; the lanes are not independent and thus do not allow passing (Fig. 4). The empirical results of [64,66] indicate a distance between lanes of  $d \approx 0.45$  m, independent of the bottleneck width  $b$ , implying a stepwise increase of capacity. However, the investigation was restricted to two values ( $b = 1.0$  m and  $b = 2.0$  m) of the width.

In contrast, the study [176] considered more values of the width and found that the lane distance increases continuously as illustrated in Fig. 4. Moreover it was shown that a continuous increase of the lane distance leads to a very weak dependence on its width of the density and velocity inside the bottleneck. Thus in reference to Eq. (2) the flow does not necessarily depend on the number of lanes. This is consistent with common guidelines and handbooks<sup>2</sup> which assume that the capacity is a linear function

<sup>2</sup>One exception is the German MVStättV [130], see above.

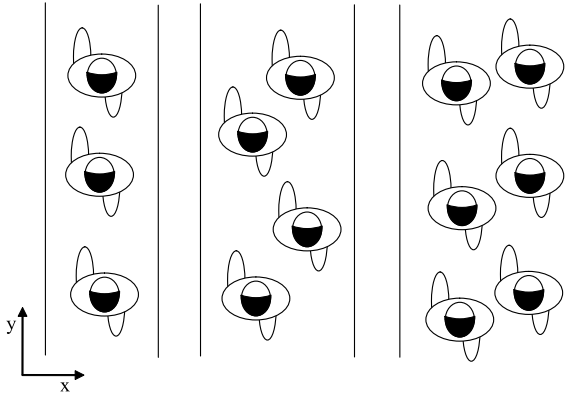

Evacuation Dynamics: Empirical Results, Modeling and Applications, Figure 4

A sketch of the zipper effect with continuously increasing lane distances in  $x$ : The distance in the walking direction decreases with increasing lateral distance. Density and velocities are the same in all cases, but the flow increases continuously with the width of the section

of the width [35,136,150,192]. It is given by the maximum of the fundamental diagram and in reference to the specific flow concept introduced in Subsect. “Observables”, Eqs. (2), (3), the maximum grows linearly with the facility width. To find a conclusive judgment on the question if the capacity grows continuously with the width the results of different laboratory experiments [93,121,122,132,176] are compared in [176].

In the following we discuss the data of flow measurement collected in Fig. 5. The corresponding setups are sketched in Fig. 6. First, note that all presented data are taken under laboratory conditions where the test persons are advised to move normally. The data by Muir et al. [121], who studied the evacuation of airplanes (see Fig. 6b), seem to support the stepwise increase of flow with the width. They show constant flow values for  $b > 0.6$  m. But the independence of flow over the large range from  $b = 0.6$  m to  $b = 1.8$  m indicates that in this special setup the flow is not restricted by the bottleneck width. Moreover, it was shown in [176] by determination of the trajectories that the distance between lanes changes continuously, invalidating the basic assumption leading to a stepwise increasing flow. Thus all collected data for flow measurements in Fig. 5 are compatible with a continuous and almost linear increase with the bottleneck width for  $b > 0.6$  m.

The data in Fig. 5 differ considerably in values of bottleneck capacity. In particular, the flow values of Nagai [132] and Müller [122] are much higher than the maxima of empirical fundamental diagrams (see Sub-

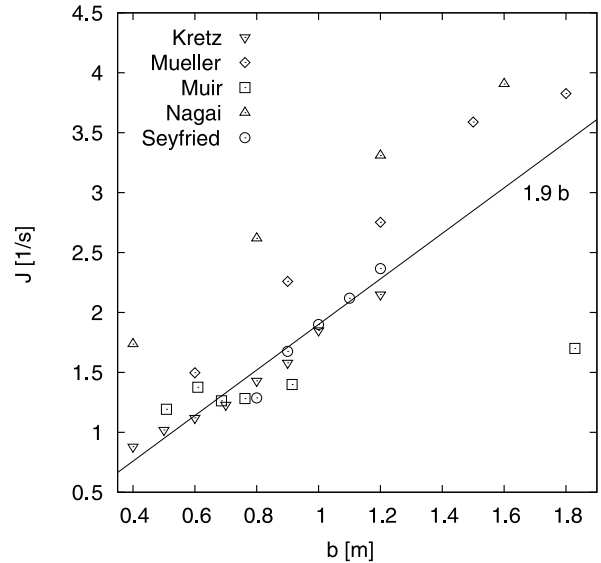

Evacuation Dynamics: Empirical Results, Modeling and Applications, Figure 5

Influence of the width of a bottleneck on the flow. Experimental data [121,122,132,176] of different types of bottlenecks and initial conditions. All data are taken under laboratory conditions where the test persons are advised to move normally

sect. “Fundamental Diagram”). The influence of “panic” or pushing can be excluded since in all experiments the participants were instructed to move normally. The comparison of the different experimental setups (Fig. 6) shows that the exact geometry of the bottleneck is of only minor influence on the flow, while a high initial density in front of the bottleneck can increase the resulting flow values. This is confirmed by the study of Nagai et al., see Figure 6 in [132]. There it is shown that for  $b = 1.2$  m the flow grows from  $J = 1.04 \text{ s}^{-1}$  to  $3.31 \text{ s}^{-1}$  when the initial density is increased from  $0.4 \text{ m}^{-2}$  to  $5 \text{ m}^{-2}$ .

The linear dependence of the flow on the width has a natural limitation due to the nonzero body-size and the asymmetry given by the sequence of movement in steps. Movement of pedestrians through bottlenecks smaller than shoulder width requires a rotation of the body. Kretz et al. found in their experiment [93] that the specific flow  $J_s$  increases if the width decreases from  $b = 0.7$  m to  $b = 0.4$  m.

**Connection Between Bottleneck Flow and Fundamental Diagrams** An interesting question is how the bottleneck flow is connected to the fundamental diagram. General results for driven diffusive systems [149] show that boundary conditions only *select* between the states of the



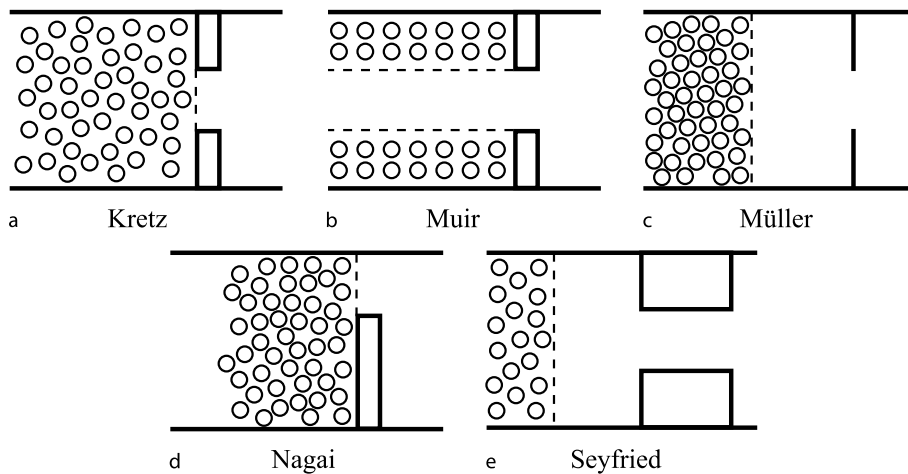

Evacuation Dynamics: Empirical Results, Modeling and Applications, Figure 6  
 Outlines of the experimental arrangements under which the data shown in Fig. 5 were taken

undisturbed system instead of creating completely different ones. Therefore it is surprising that the measured maximal flow at bottlenecks can exceed the maximum of the empirical fundamental diagram. These questions are related to the common jamming criterion. Generally, it is assumed that a jam occurs if the incoming flow exceeds the capacity of the bottleneck. In this case one expects the flow through the bottleneck to continue with the capacity (or lower values).

The data presented in [176] show a more complicated picture. While the density in front of the bottleneck amounts to  $\rho \approx 5.0(\pm 1) \text{ m}^{-2}$ , the density inside the bottleneck tunes around  $\rho \approx 1.8 \text{ m}^{-2}$ . The observation that the density inside the bottleneck is lower than in front of the bottleneck is consistent with measurements of Daamen and Hoogendoorn [20] and the description given by Predtechenskii and Milinskii in [150]. The latter assumes that in the case of a jam the flow through the bottleneck is determined by the flow in front of the bottleneck. The density inside the jam will be higher than the density associated with the capacity. Thus the reduced flow in front of the bottleneck causes a flow through the bottleneck smaller than the bottleneck capacity. Correspondingly the associated density is also smaller than that at capacity. But the discussion above cannot explain why the capacities measured at bottlenecks are significantly higher than the maxima of empirical fundamental diagrams and cast doubts on the common jamming criterion. Possible unconsidered influences are stochastic flow fluctuations, non-stationarity of the flow, flow interferences due to the necessity of local organization or changes of the incentive during the access into the bottleneck.

**Blockages in Competitive Situations** As stated above all data collected in Fig. 5 are gained by runs where the test persons were instructed to move normally. By definition a bottleneck is a limited resource and it is possible that under competitive situations pedestrian flow through bottlenecks is different from the flow in normal situations. One qualitative difference to normal situations is the occurrence of blockages. Regarding the term ‘panic’ one has to bear in mind that for the occurrence of blockages some kind of reward is essential, while the emotional state of the test persons is not. This was a result of a very interesting and often cited study by Mintz [113]. First experiments with real pedestrians have been performed by Dieckmann [24] in 1911 as a reaction to many fatalities in theater fires at the end of the 19th century. In these small scale experiments test persons were instructed to go through great trouble to pass the door as fast as possible. Even in the first run he observed a stable “wedging”. In [150] it is described how these obstruction occurs due to the formation of arches in front of the door under high pressure. This is very similar to the well-known phenomenon of *arching* occurring in the flow of granular materials through narrow openings [194].

Systematic studies including the influence of the shape and width of the bottleneck and comparisons with flow values under normal situations have been performed by Müller and Muir et al. [121,122]. Müller found that funnel-like geometries support the formation of arches and thus blockages. For further discussion, one must distinguish between temporary blockages and stable blockages leading to a zero flow. For the setup sketched in Fig. 6c Müller found that temporary blockages occur only for

$b < 1.8$  m. For  $b \leq 1.2$  m the flow shows strong pulsing due to unstable blockages. Temporal disruptions of the flow appear for  $b \leq 1.0$  m. In comparison to normal situations the flow is higher, and in general the occurrence of blockages decreases with width. However a surprising result is that for narrow bottlenecks, increasing the width can be counterproductive since it also increases the probability of blockages. Muir et al. for example note that in their setup (Fig. 6b) the enlargement of the width from  $b = 0.5$  m to  $b = 0.6$  m leads to an increase of temporary blockages. The authors explain this by differences in the perception of the situation by the test persons. While the smaller width is clearly passable only for one person, the wider width may lead to the perception that the bottleneck is sufficiently wide to allow two persons to pass through. How many people have direct access to the bottleneck is clearly influenced by the width of the corridor in front of the bottleneck. Also, Müller found hints that flow under competitive situations did not increase in general with the bottleneck width. He notes an optimal ratio of 0.75:1 between the bottleneck width and the width of the corridor in front of the bottleneck.

To reduce the occurrence of blockages, and thus evacuation times, Helbing et al. [54,55,83] suggested putting a column (asymmetrically) in front of a bottleneck. It should be emphasized that this theoretical prediction was made under the assumption that the system parameters, i. e., the basic behavior of the pedestrians, does not change in the presence of the column. This is highly questionable in real situations where a column can be perceived as an additional obstacle or can make it difficult to find the exit. In experiments [57] an increase of the flow of about 30% has been observed for a door with  $b = 0.82$  m. But this experiment was performed only for one width and the discussion above indicates the strong influence of the specific setup used. Independent of this uncertainty this concept is limited, as the occurrence of stable arches, to narrow bottlenecks. In practice narrow bottlenecks are not suitable for a large number of people and an opening in a room has other important functionalities, which would be restricted by a column.

Another finding is the observation that the total flow at bottlenecks with bidirectional movement is higher than it is for unidirectional flows [57].

## Stairs

In most evacuation scenarios stairs are important elements that are a major determinant for the evacuation time. Due to their physical dimension, which is often smaller than other parts of a building, or due to a reduced walking

speed, stairs generally must be considered as bottlenecks for the flow of evacuees. For the movement on stairs, just as for the movement on flat terrain, the fundamental diagram is of central interest. Compared to the latter there are more degrees of freedom, which influence the fundamental diagram:

- One has to distinguish between upward and downward movement.
- The influence of riser height and tread width (which determine the incline) has to be taken into account.
- For upward motion exhaustion effects lead to a strong time dependence of the free speed.

It is probably a consequence of the existence of a continuum of fundamental diagrams in dependence of the incline that there are no generally accepted fundamental diagrams for movement on stairs. However, there are studies on various details—mostly the free speed—of motion on stairs in dependence of the incline [35,38,39,46], conditions (comfortable, normal, dangerous) [151], age and sex [35], tread width [33], and the length of a stair [95]; and in consideration of various disabilities [11].

In addition there are some compilations or “meta studies”: Graat [46] compiled a list of capacity measurements and Weidmann [192] built an average of 58 single studies and found an average for the horizontal upstairs speed—the speed when the motion is projected to the horizontal level—of 0.610 m/s.

Depending on various parameters, the aforesaid studies report horizontal upward walking speeds varying over a wide range from 0.391 to 1.16 m/s. Interestingly, on one and the same short stairs it could be observed [95] that people on average walked faster up- than downwards.

There is also a model where the upstairs speed is calculated from the stair geometry (riser and tread) [183] and an empirical investigation of the collision avoidance behavior on stairs [37].

On stairs (up- as well as downward) people like to put their hand on the handrail, i. e., they tend to walk close to walls, even if there is no counterflow. This is in contrast to movement on flat terrain, where at least in situations of low density there is a tendency to keep some distance from walls.

The movement on stairs is typically associated with a reduction of the walking speed. For upward motion this follows from the increased physical effort required. This has two aspects: first, there is the physical potential energy that a pedestrian has to supply if he wants to rise in height; second, the motion process itself is more exertive – the leg has to be lifted higher – than during motion on a level, even if this motion process is executed only on the spot.

Concerning the potential energy there is no comparable effect for people going downstairs. But still one can observe jams forming at the upper end of downstairs streams. These are due to the slight hesitation that occurs when pedestrians synchronize their steps with the geometry of the (down-)stairs ahead. Therefore the bottleneck character of downstairs is less a consequence of the speed on the stairs itself and more of the transition from planar to downward movement, at least as long as the steps are not overly steep.

### Evacuations: Empirical Results

Up to now this section has focused on empirical results for pedestrian motion in rather simple scenarios. As we have seen there are many open questions where no consensus has been reached, sometimes even about the qualitative aspects. This becomes even more relevant for full-scale descriptions of evacuations from large buildings or cruise ships. These are typically a combination of many of the simpler elements, so a lack of reliable information is not surprising. In the following we will discuss several complex scenarios in more detail.

**Evacuation Experiments** In the case of an emergency, the movement of a crowd usually is more straightforward than in the general case. Commuters in a railway station, for example, or visitors of a building might have complex itineraries which are usually represented by origin-destination matrices. In the case of an evacuation, however, the aims and routes are known and usually the same, i. e., the exits and the egress routes. This is the reason why an evacuation process is rather strictly limited in space and time, i. e., its beginning and end are well-defined: the sound of the alarm, initial position of all persons, safe areas (final position of all persons), and the time at which the last person reaches the safe area. When all people have left a building or vessel and reached a safe area (or the lifeboats or life rafts), then the evacuation is finished. Therefore, it is also possible to perform evacuation trials and measure overall evacuation times. Before we go into details, we will clarify three different aspects of data on evacuation processes:

- (1) The definition and parts of evacuation time,
- (2) The different sources of data, and
- (3) The application of these data.

Concerning the evacuation time, five different phases can be distinguished [48,118,153]:

- (1) Detection time,
- (2) Awareness time,

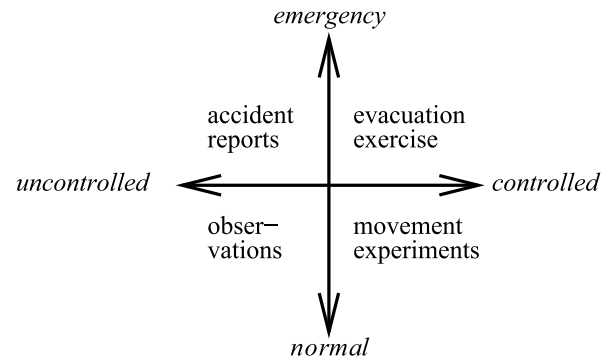

Evacuation Dynamics: Empirical Results, Modeling and Applications, Figure 7

**Empirical data can be roughly classified according to controlled/uncontrolled and emergency/normal situations**

- (3) Decision time,
- (4) Reaction time, and
- (5) Movement time.

In IMO's regulations [118,119], the first four are grouped together into *response time*. Usually, this time is called *pre-movement time*

One possible scheme for the classification of data on evacuation processes is shown in the following Fig. 7.

Please note that not only data obtained from uncontrolled or emergency situations can be used in the context of evacuation assessment. Knowledge about bottleneck capacities (i. e., flows through doors and on stairs) is especially important when assessing the layout of a building with respect to evacuation. The purpose of empirical data in the context of evacuation processes (and modeling in general) is threefold [43,71]:

- (1) Identify parameters (factors that influence the evacuation process, e. g., bottleneck widths and capacities),
- (2) Quantify (calibrate) those parameters, e. g., flow through a bottleneck in persons per meter per second, and
- (3) Validate simulation results, e. g., compare the overall evacuation time measured in an evacuation with simulation or calculation results.

The validation is usually based on data from the evacuation of complete buildings, aircraft, trains or ships. These are available from two different sources:

- (1) Full scale evacuation trials and
- (2) Real evacuations.

Evacuation trials are usually observed and videotaped. Reports of real evacuation processes are obtained from eye-

witness records and a posteriori incident investigations. Since the setting of a complete evacuation is not experimental, it is hardly possible to measure microscopic features of the crowd motion. Therefore, calibration of parameters is usually not the main purpose in evacuation trials; rather, they are carried out to gain knowledge about the overall evacuation process, the behavior of the persons, to identify the governing influences/parameters and to validate simulation results.

One major concern in evacuation exercises is the well-being of the participants. Due to practical, financial, and ethical constraints, an evacuation trial cannot be, by nature, realistic. Therefore, an evacuation exercise does not convey the increased stress of a real evacuation. To draw conclusions on the evacuation process, the walking speed observed in an exercise should not be assumed to be higher in a real evacuation [145]. Along the same lines of argument, a simplified evacuation analysis based on, e.g., a hydro-dynamic model can predict an evacuation exercise, and the same constraints apply for its results concerning the prediction of evacuation times and the evacuation process. If population parameters (such as gender, age, walking speed, etc.) are explicitly stated in the model, increased stress can be simulated by adapting these parameters.

In summary, evacuation exercises are just too expensive, time consuming, and dangerous to be a standard measure for evacuation analysis. An evacuation exercise organized by the UK Marine Coastguard Agency on the Ro-Ro ferry “Stena Invicta” held in Dover Harbor in 1996 cost more than 10,000 GBP [117]. This is one major argument for the use of evacuation simulations based on hydro-dynamic models and calculations.

**Panic, Herding, and Similar Conjectured Collective Phenomena** As already mentioned earlier in Subsect. “Collective Effects”, the concept of “panic” and its relevance for crowd disasters is rather controversial. It is usually used to describe irrational and unsocial behavior. In the context of evacuations, empirical evidence shows that this type of behavior is rare [3,17,77,178]. On the other hand there are indications that fear might be “contagious” [22]. Related concepts like “herding” and “stampede” imply a certain similarity between the behavior of human crowds and animal behavior. This terminology is quite often used in the public media. *Herding* has been described in animal experiments [166] and is difficult to measure in human crowds. However, it seems to be natural that herding exists in certain situations, e.g., limited visibility due to failing lights or strong smoke when exits are hard to find.

*Panic* As stated earlier, “panic” behavior is usually characterized by selfish and anti-social behavior which through contagion affects large groups and even leads to completely irrational actions. Often it is assumed, especially in the media, to occur in situations where people compete for scarce or dwindling resources, which in the case of emergencies are safe space or access to an exit. However, this point of view does not stand close scrutiny and it has turned out that this behavior has played no role at all in many tragic events [73,77]. For these incidents *crowd disaster* is a much more appropriate characterization.

Furthermore, lack of social behavior seems to be more frequent during so called “acquisitive panics” or “crazes” [179] than during “flight panics”. That is, social behavior seems to be less stable if there is something to gain than if there is some external danger which threatens all members of a group. Examples of crazes (acquisitive panics) include the Victoria Hall Disaster (1883) [150], the crowning ceremony of Tsar Nicholas II (1896) [168], a governmental Christmas celebration in Aracaju (2001), the distribution of free Saris in Uttar Pradesh (2004), and the opening of an IKEA store in Jeddah (2004). Crowd accidents which occur at rock concerts and religious events as well bear more similarities with crazes than with panics.

However, it is not the case that altruism and cooperation increase with danger. The events during the capsizing of the MV Estonia (see Sect. 16.6 of [100]) show some behavioral threshold: faced with immediate life-threatening danger, most people struggle for their own survival or that of close relatives.

*Herding* Herding in a broad context means “go with the flow” or “follow the crowd”. Like “panic”, the term “herding” is often used in the context of stock market crashes, i. e., causing an avalanche effect. Like “panic” the term is usually not well defined and is used in an allegoric way. Therefore, it is advisable to avoid the term in a scientific context (apart from zoology, of course). Furthermore, “herding”, “stampede”, and “panic” have a strong connotation of “deindividuation”. The conjecture of an automatic deindividuation caused by large crowds [101] has been replaced by a social attachment theory (“the typical response to a variety of threats and disasters is not to flee but to seek the proximity of familiar persons and places”) [109].

*Stampede* Stampede is – like herding – a term from zoology where herds of large mammals, such as buffalo, collectively run in one direction and might overrun any obstacles. This is dangerous for human observers if they cannot get out of the way. The term “stampede” is sometimes used

for crowd accidents [73], too. It is furthermore assumed to be highly correlated with panic. When arguing along those lines, a stampede might be the result of “crowd panic” or vice versa.

**Shock or Density Waves** Shock waves are reported for rock concerts [180] and religious events [2,58]. They might result in people standing close to each other falling down. Pressures in dense crowds of up to 4, 450 N/m<sup>2</sup> have been reported.

Although empirical data on crowd disasters exist, e. g., in the form of reports from survivors or even video footage, it is almost impossible to derive quantitative results from them. Models that aim at describing such scenarios make predictions for certain counter-intuitive phenomena that should occur. In the faster-is-slower effect [54] a higher desired velocity leads to a slower movement of a large crowd. In the freezing-by-heating effect [53] increasing the fluctuations can lead to a more ordered state. For a thorough discussion we refer to [54,55] and references therein. However, from a statistical point of view there is insufficient data to decide the relevance of these effects in real emergency situations, not least because it is almost impossible to perform “realistic” experiments.

### Sources of Empirical Data on Evacuation Processes

The evacuation of a building can either be an isolated process (due to fire restricted to this building, a bomb threat, etc.) or it can be part of the evacuation of a complete area. We will focus on the single building evacuation, here. For the evacuation of complete areas, e. g., because of flooding or hurricanes, cf. [157] and references therein.

For passenger ships, a distinction between High Speed Craft (HSC), Ro-Ro passenger ferries, and other passenger vessels (cruise ships) is made. High Speed Craft do not have cabins and the seating arrangement is similar to aircraft. Therefore, there is a separate guideline for HSC [119]. A performance-based evacuation analysis at an early stage of design is required for HSC and Ro-Pax. There is currently no such requirement for cruise ships. For an overview of IMO’s requirements and the historical development up to 2001 cf. [27]. In addition to the five components for the overall evacuation time listed above, there are three more specific to ships:

- (6) Preparation time (for the life-saving appliances, i. e., lifeboats, life-rafts, davits, chutes),
- (7) Embarkation time, and
- (8) Launching time.

Therefore, the evacuation procedure on ships is more complex than for buildings. Additionally, SAR (Search

And Rescue) is an integral part of ship evacuation.

For High Speed Craft, the time limit is 17 minutes for evacuation [70], for Ro-Ro passenger ships it is 60 minutes [118], and for all other passenger ships (e. g., cruise ships) it is 60 minutes if the number of main vertical zones is less or equal to five and 80 minutes otherwise [118]. For HSC, no distinction is made between assembly and embarkation phases.

For aircraft, the approach can be compared to that of HSC. First, an evacuation test is mandatory and there is a time limit of 90 seconds that has to be complied to in the test [31].

In many countries there is no strict criterion for the maximum evacuation time of buildings. The requirements are based on minimum exit widths and maximum escape path lengths.

A number of real evacuations has been investigated and reports are publicly available. Among the most recent ones are: Beverly Hills Club [12], MGM Grand Hotel, [12], retail store [4], department store [1], World Trade Center [47] and [www.wtc.nist.gov](http://www.wtc.nist.gov), high-rise buildings [144, 173], theater [191] for buildings, High Speed Craft “Sleipner” [138] for HSC, an overview up to 1998 [143], exit width variation [121], double deck aircraft [74], another overview for aircraft [120], and for trains [43,169].

### Modeling

A comprehensive theory of pedestrian dynamics has to take into account three different levels of behavior (Fig. 8). At the *strategic level*, pedestrians decide which activities they like to perform and the order of these activities. With

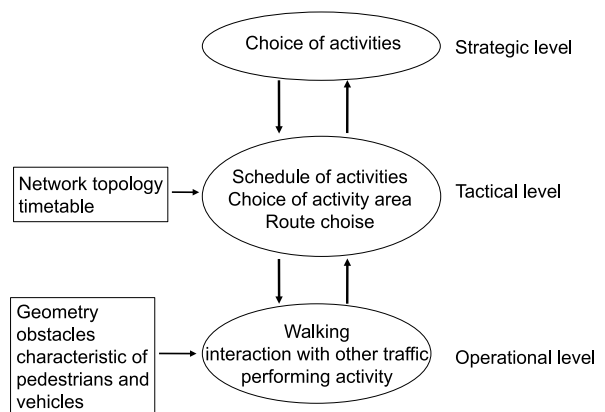

Evacuation Dynamics: Empirical Results, Modeling and Applications, Figure 8

The different levels of modeling pedestrian behavior (after [19, 65])

the choices made at the strategic level, the *tactical level* concerns the short-term decisions made by the pedestrians, e. g., choosing the precise route taking into account obstacles, density of pedestrians etc. Finally, the *operational level* describes the actual walking behavior of pedestrians, e. g., their immediate decisions necessary to avoid collisions etc.

Processes at the strategic and tactical level are usually considered to be exogenous to pedestrian simulation. Here information from other disciplines (sociology, psychology etc.) is required. In the following we will mostly be concerned with the operational level, although some of the models that we are going to describe allow us to take into account certain elements of behavior at the tactical level as well.

Modeling on the operational level is usually based on variations of models from physics. Indeed the motion of pedestrian crowds shares certain similarities with fluids and the flow of granular materials. The goal is to find models which are as simple as possible, but at the same time can reproduce “realistic” behavior in the sense that the empirical observations are reproduced. Therefore, based on the experience from physics, pedestrians are often modeled as simple “particles” that interact with each other.

There are several characteristics which can be used to classify the modeling approaches:

**Microscopic vs. macroscopic** In microscopic models each individual is represented separately. Such an approach allows us to introduce different types of pedestrians with individual properties as well as issues such as route choice. In contrast, in macroscopic models, individuals cannot be distinguished. Instead the state of the system is described by densities, usually a mass density derived from the positions of the persons and a corresponding locally averaged velocity.

**Discrete vs. continuous** Each of the three basic variables for a description of a system of pedestrians, namely space, time and state variable (e. g., velocities), can be either discrete (i. e., an integer number) or continuous (i. e., a real number). Here all combinations are possible. In a cellular automaton approach all variables are by definition discrete, whereas in hydrodynamic models all are continuous. These are the most common choices, but other combinations are used as well. Sometimes for a cellular automata approach a continuous time variable is also allowed. In computer simulation this is realized through a *random-sequential update* where at each step the particle or site to be updated (moved) is chosen randomly (from *all* particles or sites, respectively). A discrete time is usually real-

ized through a *parallel* or *synchronous update* where all particles or sites are moved at the same time. This introduces a timescale. In so-called coupled map lattices time is discrete, whereas space and state variables are continuous.

**Deterministic vs. stochastic** The dynamics of pedestrians can either be deterministic or stochastic. In the first case the behavior at a certain time is completely determined by the present state. In stochastic models, behavior is controlled by certain probabilities such that the agents can react differently in the same situation. This is one of the lessons learnt from the theory of complex systems where it has been shown for many examples that through introduction of stochasticity into rather simple systems very complex behavior can be generated. On the other hand, the stochasticity in the models reflects our lack of knowledge of the underlying physical processes that, e. g., determine the decision-making of the pedestrians. Through stochastic behavioral rules it often becomes possible to generate a rather realistic representation of complex systems such as pedestrian crowds.

This “intrinsic” stochasticity should be distinguished from “noise”. Sometimes external noise terms are added to the *macroscopic* observables, such as position or velocity. Often the main effect of these terms is to avoid certain special configurations which are considered to be unrealistic, like completely blocked states. Otherwise the behavior is very similar to the deterministic case. For true stochasticity, on the other hand, the deterministic limit usually has very different properties from the generic case.

**Rule-based vs. force-based** Interactions between the agents can be implemented in at least two different ways: In a rule-based approach agents make “decisions” based on their current situation, the nature of their neighborhood as well as their goals, etc. It focuses on the *intrinsic properties* of the agents and thus the rules are often justified from psychology. In force-based models, agents “feel” a force exerted by others and the infrastructure. They therefore emphasize *extrinsic properties* and their relevance for the motion of the agents. This is a physical approach based on the observation that the presence of others leads to deviations from a straight motion. In analogy to Newtonian mechanics a force is made responsible for these accelerations.

Cellular automata are typically rule-based models, whereas, e. g., the social-force model belongs to the force-based approaches. However, sometimes a clear

distinction cannot be made; many models combine aspects of both approaches.

**High vs. low fidelity** *Fidelity* here refers to the apparent realism of the modeling approach. High fidelity models try to capture the complexity of decision making, actions, etc. that constitute pedestrian motion in a realistic way. In contrast, in the simplest models pedestrians are represented by particles without any intelligence. Usually the behavior of these particles is determined by “forces”. This approach can be extended, e. g., by allowing different “internal” states of the particles so that they react differently to the same force depending on the internal state. This can be interpreted as some kind of “intelligence” and leads to more complex approaches, like multi-agent models. Roughly speaking, the number of parameters in a model is a good measure for fidelity in the sense introduced here, but note that higher fidelity does not necessarily mean that empirical observations are reproduced better!

It should be mentioned that a clear classification according to the characteristics outlined here is not always possible. In the following we will describe some model classes in more detail.

### Fluid-dynamic and Gas kinetic Models

Pedestrian dynamics has some obvious similarities with fluids. For example, the motion around obstacles appears to follow “streamlines”. Motion at intermediate densities is restricted (short-ranged correlations). Therefore it is not surprising that, very much like for vehicular dynamics, the earliest models of pedestrian dynamics took inspiration from hydrodynamics or gas-kinetic theory [50,61,68,69]. Typically these macroscopic models are deterministic, force-based and of low fidelity.

Henderson [60,61] has tried to establish an analogy of large crowds with a classical gas. From measurements of motion in different crowds in a low density (“gaseous”) phase he found good agreement of the velocity distribution functions with Maxwell-Boltzmann distribution [60].

Motivated by this observation, he later developed a fluid-dynamic theory of pedestrian flow [61]. Describing the interactions between the pedestrians as a collision process where the particles exchange momenta and energy, a homogeneous crowd can be described by the well-known kinetic theory of gases. However, the interpretation of the quantities is not entirely clear, e. g., what the analogues of pressure and temperature are in the context of pedestrian motion. Temperature could be identified with the velocity

variance, which is related to the distribution of desired velocities, whereas the pressure expresses the desire to move against a force in a certain direction.

The applicability of classical hydrodynamic models is based on several conservation laws. The conservation of mass, corresponding to conservation of the total number of pedestrians, is expressed through a continuity equation of the form

$$\frac{\partial \rho(\mathbf{r}, t)}{\partial t} + \nabla \cdot \mathbf{J}(\mathbf{r}, t) = 0, \quad (6)$$

which connects the local density  $\rho(\mathbf{r}, t)$  with the current  $\mathbf{J}(\mathbf{r}, t)$ . This equation can be generalized to include source and sink terms. However, the assumption of conservation of energy and momentum is not true for interactions between pedestrians which in general do not even satisfy Newton’s Third Law (“actio = reaction”). In [50] several other differences to normal fluids were pointed out, e. g., the anisotropy of interactions or the fact that pedestrians usually have an individual preferred direction of motion.

In [50] a better founded fluid-dynamical description was derived on the basis of a gas kinetic model which describes the system in terms of a density function  $f(\mathbf{r}, \mathbf{v}, t)$ . The dynamics of this function are determined by Boltzmann’s transport equation that describes its change for a given state as difference of inflow and outflow due to binary collisions.

An important new aspect in pedestrian dynamics is the existence of desired directions of motion which allows us to distinguish different groups  $\mu$  of particles. The corresponding densities  $f_\mu$  change in time due to four different effects:

1. A relaxation term with characteristic time  $\tau$  describes tendency of pedestrians to approach their intended velocities.
2. The interaction between pedestrians is modeled by a Stosszahlansatz as in the Boltzmann equation. Here, pair interactions between types  $\mu$  and  $\nu$  occur with a total rate that is proportional to the densities  $f_\mu$  and  $f_\nu$ .
3. Pedestrians are allowed to change from type  $\mu$  to  $\nu$  which, e. g., accounts for turning left or right at a crossing.
4. Additional gain and loss terms allow us to model entrances and exits where pedestrian can enter or leave the system.

The resulting fluid-dynamic equations derived from this gas kinetic approach are similar to that of ordinary fluids. However, due to the different types of pedestrians, corre-

sponding to individuals who have approximately the same desired velocity, one actually obtains a set of coupled equations describing several interacting fluids. These equations contain additional characteristic terms describing the approach to the intended velocity and the change of fluid-type due to interactions in avoidance maneuvers.

Equilibrium is approached through the tendency to walk with the intended velocity, not through interactions as in ordinary fluids. Momentum and energy are not conserved in pedestrian motion, but the relaxation towards the intended velocity describes a tendency to restore these quantities.

Unsurprisingly for a macroscopic approach, the gasekinetic models have problems at low densities. For a discussion, see e. g. [50].

**Hand Calculation method** For practical applications effective engineering tools have been developed from the hydrodynamical description. In engineering these are often called *hand calculation methods*. One could also classify some of them as queuing models since the central idea is to describe pedestrian dynamics as flow on a network with links of limited capacities. These methods allow us to calculate evacuation times in a relatively simple way that does not require any simulations. Parameters entering in the calculations can be adapted to the situation that is studied. Often they are based on empirical results, e. g., evacuation trials. Details about this kind of model can be found in Subsect. “**Calculation of Evacuation Times**”.

### Social-Force Models

The social-force model [52] is a deterministic continuum model in which interactions between pedestrians are implemented by using the concept of a *social force* or *social field* [103]. It is based on the idea that changes in behavior can be understood in terms of fields or forces. Applied to pedestrian dynamics, the social force  $\mathbf{F}_j^{(\text{soc})}$  represents the influence of the environment (other pedestrians, infrastructure) and changes the velocity  $\mathbf{v}_j$  of pedestrian  $j$ . Thus it is responsible for acceleration which justifies the interpretation as a force. The basic equation of motion for a pedestrian of mass  $m_j$  is then of the general form

$$\frac{d\mathbf{v}_j}{dt} = \mathbf{f}_j^{(\text{pers})} + \mathbf{f}_j^{(\text{soc})} + \mathbf{f}_j^{(\text{phys})} \quad (7)$$

where  $\mathbf{f}_j^{(\text{soc})} = \frac{1}{m_j} \mathbf{F}_j^{(\text{soc})} = \sum_{l \neq j} \mathbf{f}_{jl}^{(\text{soc})}$  is the total (specific) force due to other pedestrians.  $\mathbf{f}_j^{(\text{pers})}$  denotes a “personal” force which makes a pedestrian attempt to move with his or her own preferred velocity  $\mathbf{v}_j^{(0)}$  and thus acts as a driving

term. It is given by

$$\mathbf{f}_j^{(\text{pers})} = \frac{\mathbf{v}_j^{(0)} - \mathbf{v}_j}{\tau_j} \quad (8)$$

where  $\tau_j$  is reaction or acceleration time. In high density situations, physical forces  $\mathbf{f}_{jl}^{(\text{phys})}$  also become important, e. g., friction and compression when pedestrians make contact.

The most important contribution to the social force  $\mathbf{f}_j^{(\text{soc})}$  comes from the territorial effect, i. e., the private sphere. Pedestrians feel uncomfortable if they get too close to others, which effectively leads to a repulsive force between them. Similar effects are observed for the environment, e. g., people prefer not to walk too close to walls.

Since social forces are difficult to determine empirically, some assumptions must be made. Usually an exponential form is assumed. Describing the pedestrians as disks of radius  $R_j$  and position (of the center of mass)  $\mathbf{r}_j$ , the typical structure of the force between the pedestrians is described by [54]

$$\mathbf{f}_{jl}^{(\text{soc})} = A_j \exp\left[\frac{R_{jl} - \Delta r_{jl}}{\xi_j}\right] \mathbf{n}_{jl} \quad (9)$$

with  $R_{jl} = R_j + R_l$ , the sum of the disk radii,  $\Delta r_{jl} = |\mathbf{r}_j - \mathbf{r}_l|$ , the distance between the centers of mass,  $\mathbf{n}_{jl} = \mathbf{r}_j - \mathbf{r}_l / \Delta r_{jl}$ , the normalized vector pointing from pedestrian  $l$  to  $j$ .  $A_j$  can be interpreted as strength,  $\xi_j$  as the range of the interactions.

The appeal of the social-force model is given mainly by analogy to Newtonian dynamics. For the solution of the equations of motion of Newtonian many-particle systems, well-founded molecular dynamics techniques exist. However, in most studies so far the distinctions between pedestrian and Newtonian dynamics are not discussed in detail. A straightforward implementation of the equations of motion neglecting these distinctions can lead to unrealistic movement of single pedestrians. For example, negative velocities in the main moving direction cannot be excluded in general even if asymmetric interactions (violating Newton’s Third Law) between the pedestrians are chosen. Another effect is the occurrence of velocities higher than the preferred velocity  $v_j^{(0)}$  due to the forces on pedestrians in the moving direction. To prevent this effect, additional restrictions for the degrees of freedom must be introduced, see for example [52], or the superposition of forces has to be discarded [175]. A general discussion of the limited analogy between Newtonian dynamics and the social-force model as well as the consequences for model implementations is still missing.



Apart from the ad hoc introduction of interactions, the structure of the social-force model can also be derived from an extremal principle [62,63]. It follows under the assumption that pedestrian behavior is determined by the desire to minimize a certain cost function which takes into account not only kinematic aspects and walking comfort, but also deviations from a planned route.

### Cellular Automata

Cellular automata (CA) are rule-based dynamical models that are discrete in space, time and state variable which in the case of traffic usually corresponds to velocity. Discreteness in time means that the positions of the agents are updated in well defined steps. In computer simulations this is realized through a *parallel* or *synchronous* update where all pedestrians move at the same time. The time step corresponds to a natural timescale  $\Delta t$  which could be identified, e. g., with some reaction time. This can be used for the calibration of the model which is essential for making quantitative predictions. A natural space discretization can be derived from the maximal densities observed in dense crowds which gives the minimal space requirement of one person. Usually each cell in the CA can be occupied by only one particle (exclusion principle) so that this space requirement can be identified with the cell size. In this way, a maximal density of  $6.25 \text{ P/m}^2$  [192] leads to a cell size of  $40 \times 40 \text{ cm}^2$ . Sometimes finer discretizations are more appropriate (see Subsect. “Theoretical Results”). In this case pedestrians correspond to extended particles that occupy more than one cell (e. g., four cells). The exclusion principle and the modeling of humans as non-compressible particles mimics short-range repulsive interactions, i. e., the “private-sphere”.

The dynamics are usually defined by rules which specify transition probabilities for motion to one of the neighboring cells (Fig. 9). The models differ in the specification of these probabilities as well in that of the “neighborhood”. For deterministic models, all but one are of probability zero.

The first cellular automata (CA) models [7,41,89,129] for pedestrian dynamics can be considered two-dimensional variants of the asymmetric simple exclusion process (ASEP) (for reviews, see [9,23,172]) or models for city or highway traffic [6,16,133] based on it. Most of these models represent pedestrians by particles without any internal degrees of freedom. They can move to one of the neighboring cells based on certain transition probabilities which are determined by three factors:

(1) The desired direction of motion, e. g., to find the shortest connection,

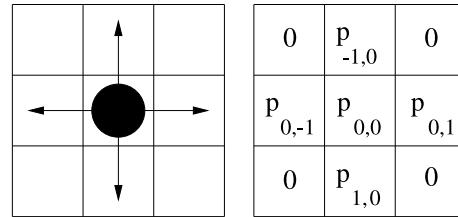

Evacuation Dynamics: Empirical Results, Modeling and Applications, Figure 9

A particle, its possible directions of motion and the corresponding transition probabilities  $p_{ij}$  for the case of a von Neumann neighborhood

- (2) Interactions with other pedestrians, and
- (3) Interactions with the infrastructure (walls, doors, etc.).

**Fukui–Ishibashi Model** One of the first CA models for pedestrian dynamics was proposed by Fukui and Ishibashi [40,41] and is based on a two-dimensional variant of the ASEP. They studied bidirectional motion in a long corridor where particles moving in opposite directions were updated alternatingly. Particles move deterministically in their desired direction; only if the desired cell is occupied by an oppositely moving particle do they make a random sidestep.

Various extensions and variations of the model have been proposed, e. g., an asymmetric variant [129] where walkers prefer lane changes to the right, different update types [193], simultaneous (exchange) motion of pedestrians standing “face-to-face” [72], or the possibility of backstepping [107]. The influence of the shape of the particles has been investigated in [131]. Also other geometries [128, 181] and extensions to full 2-dimensional motion have been studied in various modifications [106,107,127]

**Blue–Adler Model** The model of Blue and Adler [7,8] is based on a variant of the Nagel–Schreckenberg model [133] of highway traffic. Pedestrian motion is considered in analogy to a multi-lane highway. The structure of the rules is similar to the basic two-lane rules suggested in [159]. The update is performed in four steps which are applied to all pedestrians in parallel. In the first step each pedestrian chooses a preferred lane. In the second step the lane changes are performed. In the third step the velocities are determined based on the available gap in the new lanes. Finally, in the fourth step the pedestrians move forward according to the velocities determined in the previous step.

In counterflow situations head-on-conflicts occur. These are resolved stochastically and with some probability opposing pedestrians are allowed to exchange positions within one time step. Note that the motion of a single pedestrian (not interacting with others) is deterministic otherwise.

Unlike the Fukui–Ishibashi model, motion is not restricted to nearest-neighbor sites. Instead, pedestrians can have different velocities  $v_{\max}$  which correspond to the maximal number of cells they are allowed to move forward. In contrast to vehicular traffic, acceleration to  $v_{\max}$  can be assumed to be instantaneous in pedestrian motion.

In order to study the effects of inhomogeneities, the pedestrians are assigned different maximal velocities  $v_{\max}$ . Fast walkers have  $v_{\max} = 4$ , standard walkers  $v_{\max} = 3$  and slow walkers  $v_{\max} = 2$ . The cell size is assumed to be  $50 \text{ cm} \times 50 \text{ cm}$ . The best agreement with empirical observations has been achieved with 5% slow and 5% fast walkers [8]. Furthermore the fundamental diagram in more complex situations, such as bi- or four-directional flows, has been investigated.

**Gipps–Marksjös Model** A more sophisticated discrete model was suggested by Gipps and Marksjös [45] in 1985. One motivation for developing a discrete model was the limited computer power at that time. Therefore a discrete model, which reproduces the properties of pedestrian motion realistically, was in many respects a real improvement over the existing continuum approaches.

Interactions between pedestrians are assumed to be repulsive, anticipating the idea of social forces (see Subsect. “**Social-Force Models**”). The pedestrians move on a grid of rectangular cells of size  $0.5 \times 0.5 \text{ m}$ . To each cell a score is assigned based on its proximity to other pedestrians. This score represents the repulsive interactions and actual motion is then determined by the competition between these repulsions and the gain of approaching the destination. Applying this procedure to all pedestrians, a potential value is assigned to each cell which is the sum of the individual contributions. The pedestrian then selects the cell of its nine neighbors (Moore neighborhood) which leads to the maximum benefit. This benefit is defined as the difference between the gain of moving closer to the destination and the cost of moving closer to other pedestrians as represented by the potential. This requires a suitable chosen gain function  $P$ .

The updating is done sequentially to avoid conflicts of several pedestrians trying to move to the same position. In order to model different velocities, faster pedestrians are updated more frequently. Note that the model dynamics are deterministic.

**Floor Field CA** Floor field CA [13,14,83,167] can also be considered as an extension of the ASEP. However, the transition probabilities to neighboring cells are no longer fixed but vary dynamically. This is motivated by the process of chemotaxis (see [5] for a review) used by some insects (e. g., ants) for communication. They create a chemical trace to guide other individuals to food sources. In this way a complex trail system is formed that has many similarities with human transport networks.

In the approach of [13] the pedestrians also create a trace. In contrast to chemotaxis, however, this trace is only virtual, although one could assume that it corresponds to some abstract representation of the path in the mind of the pedestrians. Although this is mainly a technical trick which reduces interactions to local ones that allow efficient simulations in arbitrary geometries, one could also think of the trail as representation of the paths in the mind of a pedestrian. The locality becomes important in complex geometries as no algorithm is required to check whether the interaction between particles is screened by walls, etc. The number of interaction terms always grows linearly with the number of particles.

The translation into local interactions is achieved by the introduction of so-called *floor fields*. The transition probabilities for all pedestrians depend on the strength of the floor fields in their neighborhood in such a way that transitions in the direction of larger fields are preferred. The *dynamic floor field*  $D_{ij}$  corresponds to a virtual trace which is created by the motion of the pedestrians and in turn influences the motion of other individuals. Furthermore it has its own dynamics, namely through diffusion and decay, which leads to a dilution and finally the vanishing of the trace after some time. The *static floor field*  $S_{ij}$  does not change with time since it only takes into account the effects of the surroundings. Therefore it exists even without any pedestrians present. It allows us to model, e. g., preferred areas, walls and other obstacles. Figure 10 shows the static floor field used for the simulation of evacuations from a room with a single door. Its strength decreases with increasing distance from the door. Since the pedestrians prefer motion into the direction of larger fields, this is already sufficient to find the door.

Coupling constants control the relative influence of both fields. For a strong coupling to the static field pedestrians will choose the shortest path to the exit. This corresponds to a ‘normal’ situation. A strong coupling to the dynamic field implies a strong herding behavior where pedestrians try to follow the lead of others. This often happens in emergency situations.

The model uses a fully parallel update. Therefore conflicts can occur where different particles choose the same

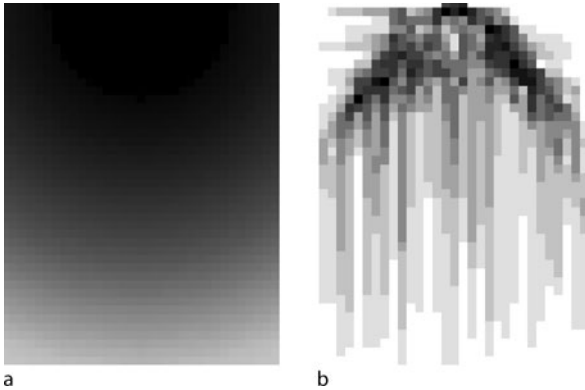

Evacuation Dynamics: Empirical Results, Modeling and Applications, Figure 10

**Left:** Static floor field for the simulation of an evacuation from a large room with a single door. The door is located in the middle of the upper boundary and the field strength increases with increasing intensity. **Right:** Snapshot of the dynamical floor field created by people leaving the room

destination cell. This is relevant for high density situations and happens in all models with parallel update if motion in different directions is allowed. Conflicts have been considered a technical problem for a long time and usually the dynamics have been modified in order to avoid them. The simplest method is to update pedestrians sequentially instead of using fully parallel dynamics. However, this leads to other problems, e. g., the identification of the relevant timescale. Therefore it has been suggested in [84,85] to take these conflicts seriously as an important part of the dynamics.

For the floor field model it has been shown in [85] that the behavior becomes more realistic if not all conflicts are resolved by allowing one pedestrian to move while the others stay at their positions. Instead with probability  $\mu \in [0, 1]$ , which is called the friction parameter, the movement of *all* involved pedestrians is denied [85] (see Fig. 11).

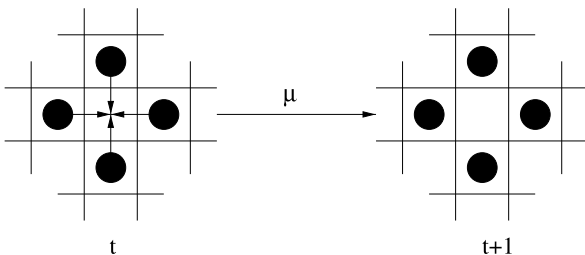

Evacuation Dynamics: Empirical Results, Modeling and Applications, Figure 11

Refused movement due to the friction parameter  $\mu$  (for  $m = 4$ )

This allows one to describe clogging effects between the pedestrians in a much more detailed way [85].  $\mu$  works as some kind of local pressure between the pedestrians. If  $\mu$  is high, the pedestrians handicap each other trying to reach their desired target sites. This local effect can have enormous influence on macroscopic quantities like flow and evacuation time [85]. Note that the kind of friction introduced here only influences interacting particles, not the average velocity of a freely moving pedestrian.

Surprisingly, the qualitative behaviors of the floor field model and the social-force models are very similar despite the fact that the interactions are very different. In the floor field model interactions are attractive, whereas in the social-force model they are repulsive. However, in the latter interactions are between particle densities. In contrast, in the floor field model the particle density interacts with the velocity density.

### Other Approaches

**Lattice-gas models** In 1986, Frisch, Hasslacher, and Pomeau [34] showed that one does not have to take into account detailed molecular motion within fluids in order to obtain a realistic picture of (2d) fluid dynamics. They proposed a lattice gas model [164,165] on a triangular lattice with hexagonal symmetry, which is similar in spirit to CA models, but the exclusion principle is relaxed: particles with different velocities are allowed to occupy the same site. Note that the allowed velocities differ only in the direction, not absolute value. The dynamics are based on a succession of collision and propagation that can be chosen in such a way that the coarse-grained averages of this microscopic dynamic is asymptotically equivalent to the Navier–Stokes equations of incompressible fluids.

In [108] a kind of mesoscopic approach inspired by these lattice gas models has been suggested as a model for pedestrian dynamics. In analogy with the description of transport phenomena in fluids (e. g., the Boltzmann equation) the dynamics are based on a succession of collision and propagation.

Pedestrians are modeled as particles, moving on a triangular lattice, which have a preferred direction of motion  $\mathbf{c}_F$ . However, the particles do not strictly follow this direction but also have a tendency to move with the flow. Furthermore, at high densities the crowd motion is influenced by a kind of friction which slows down the pedestrians. This is achieved by reducing the number of individuals allowed to move to neighboring sites.

As in a lattice gas model [165], the dynamics now consists of two steps. In the *propagation step* each pedestrian moves to the neighbor site in the direction of its velocity

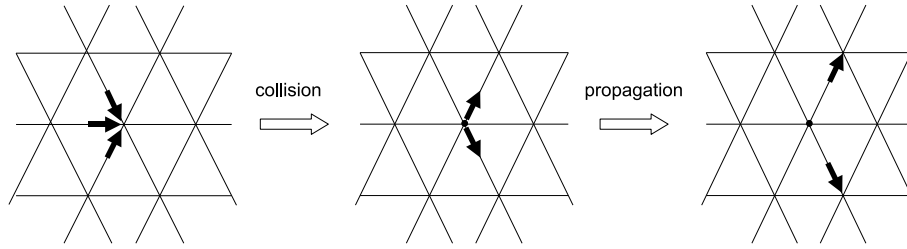

Evacuation Dynamics: Empirical Results, Modeling and Applications, Figure 12

The dynamics of lattice gas models proceed in two steps. Pedestrians coming from neighboring sites interact in the collision step where velocities are redistributed. In the propagation step the pedestrians move to neighbor sites in directions determined by the collision step

vector. In the *collision step* the particles interact and new velocities (directions) are determined. In contrast to physical systems, momentum, etc., does not need to be conserved during the collision step. These considerations lead to a collision step that takes into account the favorite direction  $\mathbf{c}_F$ , the local density (the number of pedestrians at the collision site), and a quantity called mobility at all neighbor sites which is a normalized measure of the local flow after the collision.

**Optimal-Velocity Model** The optimal velocity (OV) model originally introduced for the description of highway traffic can be generalized to higher dimensions [134] which allows its application to pedestrian dynamics.

In the two-dimensional extension of the OV model the equation of motion for particle  $i$  is given by

$$\frac{d^2}{dt^2}\mathbf{x}_i(t) = a \left\{ \mathbf{v}_0 + \sum_j \mathbf{v}(\mathbf{x}_j(t) - \mathbf{x}_i(t)) - \frac{d}{dt}\mathbf{x}_i(t) \right\}, \quad (10)$$

where  $\mathbf{x}_i = (x_i, y_i)$  is the position of particle  $i$ . It can be considered as a special case of the general social-force model (7) without physical forces. The optimal-velocity function

$$\mathbf{V}(\mathbf{x}_j - \mathbf{x}_i) = f(r_{ij})(1 + \cos \varphi)\mathbf{n}_{ij}, \quad (11)$$

$$f(r_{ij}) = \alpha \{ \tanh \beta(r_{ij} - b) + c \}, \quad (12)$$

where  $r_{ij} = |\mathbf{x}_j - \mathbf{x}_i|$ ,  $\cos \varphi = (x_j - x_i)/r_{ij}$  and  $\mathbf{n}_{ij} = (\mathbf{x}_j - \mathbf{x}_i)/r_{ij}$  is determined by interactions with other pedestrians.  $\mathbf{v}_0$  is a constant vector that represents a ‘desired velocity’ at which an isolated pedestrian would move. The strength of the interaction depends on the distance  $r_{ij}$  between the  $i$ th and  $j$ th particles, and on the angle  $\varphi$  between the directions of  $\mathbf{x}_j - \mathbf{x}_i$  and the current velocity  $d\mathbf{x}_i/dt$ . Due to the term  $(1 + \cos \varphi)$ , a particle reacts more sensitively to particles in front than to those behind.

Now two cases can be distinguished: repulsive and attractive interactions. The former is relevant for pedestrian dynamics whereas the latter is more suitable for biological motion. Therefore, for pedestrian motion one chooses  $c = 1$  which implies  $f < 0$ .

A detailed analysis [134] shows that the model exhibits a rich phase diagram including the formation of various patterns.

**Other Models** We briefly mention a few other model approaches that have been suggested. In [10] a discretized version of the social-force model has been introduced and shown to reproduce qualitatively the observed collective phenomena.

In [141] a magnetic force model has been proposed where pedestrians and their goals are treated as magnetic poles of opposite sign.

Another class of models is based on ideas from queuing theory. In principle, some hand calculation methods can be considered as macroscopic queuing models. Typically, rooms are represented as nodes in the queuing network and links correspond to doors. In microscopic approaches, in the movement process each agent chooses a new node, e. g., according to some probability [105].

## Theoretical Results

As emphasized in Subject. “**Collective Effects**”, the collective effects observed in the motion of pedestrian crowds are a direct consequence of microscopic dynamics. These effects are reproduced quite well by some models, e. g., the social-force and floor-field model, at least on a qualitative level. As mentioned before, the qualitative behavior of the two models is rather similar despite the very different implementation of the interactions. This indicates a certain robustness of the collective phenomena observed.

As an example we discuss the formation of lanes in counterflow formation. Empirically one observes a strong

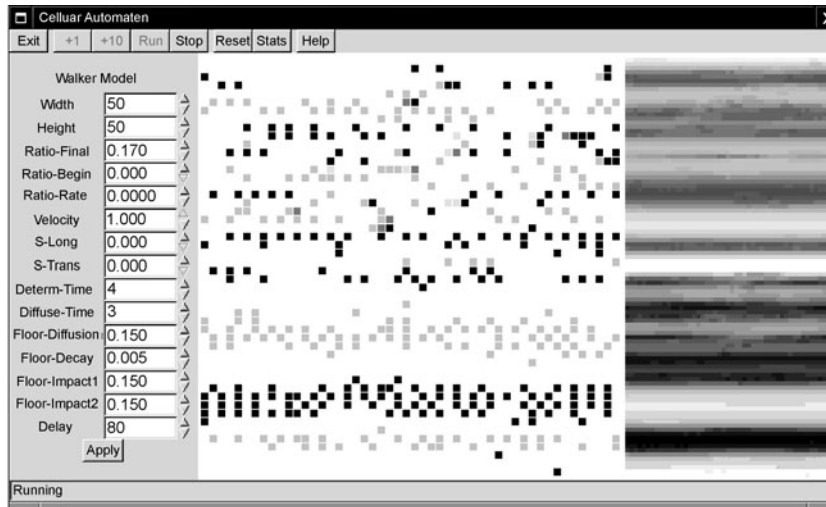

Evacuation Dynamics: Empirical Results, Modeling and Applications, Figure 13

Lane formation in the floor-field model. The central window is the corridor and the light and dark squares are right- and left-moving pedestrians, respectively. In the bottom part well-separated lanes can be observed whereas in the top part the motion is still disordered. The right part of the figure shows the floor fields for the right-movers (*upper half*) and left-movers (*lower half*)

tendency to follow immediately in the “wake” of another person heading in the same direction. Such lane formation was reproduced in the social-force model [52,53] as well as in the floor-field model [13,76] (see Fig. 13). While the formation of lanes in general is essential to avoid deadlocks and thus keep the chance of reproducing realistic fluxes, the number of direction changes per meter cross section is a parameter which in reality crucially depends on the situation [76]: the longer a counterflow situation is assumed to persist, the fewer lanes per meter cross section can be found. The correct reproduction of counterflow is an issue for an accommodating animation, but more or less unimportant for macroscopic observables. This is probably the main reason why there seems to have been little effort put into the attempt to reproduce different “kinds” of lane formation in a controlled, situation-dependent manner.

On the quantitative side, the fundamental diagram is the first and most serious test for any model. Since most quantitative results rely on the fundamental diagram, it can be considered the most important characteristic of pedestrian dynamics. It is not only relevant for movement in a corridor or through a bottleneck, but also as an important determinant of evacuation times. However, as emphasized earlier, there is currently no consensus on the empirical form of the fundamental diagram. Therefore, a calibration of the model parameters is currently difficult.

Most cellular automata models are based on the asymmetric simple exclusion process. This strictly one-dimensional stochastic process has a fundamental diagram which is symmetric around density  $\rho = 1/2$ . Lane changes in two-dimensional extensions lead to only a small shift towards smaller densities. Despite the discrepancies in the empirical results, an almost symmetric fundamental diagram can be excluded.

Based on the experience with modeling of highway traffic [16,133], models with higher speeds have been introduced which naturally lead to an asymmetric fundamental diagram. Typically this is implemented by allowing the agents to move more than one cell per update step [82, 86,87,92,195,196]. These model variants have been shown to be flexible enough to reproduce, e. g., Weidmann’s fundamental diagram for the flow in a corridor [192] with high precision. Usually in the simulations a homogeneous population is assumed. However, in reality, different pedestrians have different properties such as walking speed, motivation, etc. This is easily taken into account in every microscopic model. There are many parameters that could potentially have an influence on the fundamental diagram. However, the current empirical situation does not allow to decide this question.

Another problem occurring in CA models has its origin in the discreteness of space. Through the choice of the lattice discretization, space is no longer isotropic. Motion in directions not parallel to the main axis of the lattice are

difficult to realize and can only be approximated by a sequence of steps parallel to the main directions.

Higher velocities also require the extension of the neighborhood of a particle which is no longer identical to the cells adjacent to the current position. A natural definition of “neighborhood” corresponds to those cells that could be reached within one time step. In this way the introduction of higher velocities also reduces the problem of space isotropy as the neighborhoods become more isotropic for larger velocities.

Other solutions to this problem have been proposed. One way is to count the number of diagonal steps and let the agent suspend from moving following certain rules which depend on the number of diagonal steps [171]. A similar idea is to sum up the real distance that an agent has moved during one round: a diagonal step counts  $\sqrt{2}$  and a horizontal or vertical step counts 1. An agent has to finish its round as soon as this sum is bigger than its speed [87]. A third possibility – which works for arbitrary speeds – is to assign selection probabilities to each of the four lattice positions adjacent to the exact final position [195,196]. Naturally these probabilities are inversely proportional to the square area between the exact final position and the lattice point, as in this case the probabilities are normalized by construction if one has a square lattice with points on all integer number combinations. However, one also could think of other methods to calculate the probability.

For the social-force model, the specification of the repulsive interaction (with and without hard core, exponential or reciprocal with distance) as well as the parameter sets for the forces changes in different publications [52,53,54,114]. In [55] the authors state that “most observed self-organization phenomena are quite insensitive to the specification of interaction forces”. However, at least for the fundamental diagram, a relation connected with all phenomena in pedestrian dynamics, this statement is questionable. As remarked in [56] the reproduction of the fundamental diagram “requires a less simple specification of the repulsive interaction forces”. Indeed in [175] it was shown that the choice of hard-core forces or repulsive soft interactions as well as the particular parameter set can strongly influence the resulting fundamental diagram regarding qualitative as well as quantitative effects.

Also a more realistic behavior at higher densities requires a modification of the basic model. Here the use of density-dependent desired velocities leads to a reduction of the otherwise unrealistically large number of collisions [10].

The particular specification of forces and the previously mentioned problem with Newton’s Third law can

lead in principle to some unwanted effects, such as momentary velocities larger than the preferred velocity [52] or the penetration of pedestrians into each other or into walls [98]. It is possible that these effects can be suppressed for certain parameter sets by contact or friction forces, but the general appearance is not excluded. Only in the first publication [52] are restrictions for the velocity explicitly formulated to prevent velocities larger than the intended speed; other authors tried to improve the model by introducing more parameters [98]. But additional parameter and artificial restrictions of variables diminish the simplicity and thus the attractiveness of the model. A general discussion of how to deal with these problems of the social-force model and a verification that the observed phenomena are not limited to a certain specification of the interaction and a special parameter set is up to now still missing.

While realistic reproduction within the empirical range of these macroscopic observables, especially the fundamental diagram, is absolutely essential to guarantee safety standards in evacuation simulations, and while a user should always be distrustful of models where no fundamental diagram has ever been published, it is by no means sufficient to exclusively check for the realism of macroscopic observables. On the microscopic level there are a large number of phenomena which need to be reproduced realistically, be it just to make a simulation animation look realistic or because microscopic effects can often easily influence macroscopic observables.

If one compares simulations of bottleneck flows with real events, one observes that in simulations the form of the queue in front of bottlenecks is often a half-circle, while in reality it is drop- or wedge-shaped. In most cases this discrepancy probably does not have an influence on the simulated evacuation time, but it is interesting to note where it originates from. Most simulation models implicitly or explicitly use some kind of utility maximization to steer the pedestrians – with the utility being foremost inversely proportional to the distance from the nearest exit. This obviously leads to half-circle-shaped queues in front of bottlenecks. So wherever one observes queues different than half-circles, people have exchanged their normal “utility function based on the distance” with something else. One such alternative utility function could be that people are just curious about what is inside or behind the bottleneck, so they seek a position where they can look into it. A more probable explanation would be that in any case it is the time distance not the spatial distance which is sought to be minimized. As anyone knows what the inescapable loss in time a bottleneck means for the whole waiting group, the precise waiting spot is not that impor-

tant. However, in societies with a strong feeling for equality, people would strongly wish to equally distribute the waiting time and keep a first-in-first-out principle, which can best be accomplished and controlled when the queue is more or less one-dimensional, respectively just as wide as the bottleneck itself.

Finally it should be mentioned that theoretical investigations based on simulations of models for pedestrian dynamics have led to the prediction of some surprising and counter-intuitive collective phenomena, such as the reduction of evacuation times through additional columns near exits (see Subsect. “**Bottleneck Flow**”) or the faster-is-slower [54] and freezing-by-heating effect [53]. However, so far the empirical evidence for the relevance or even the occurrence of these effects in real situations is rather scarce.

## Applications

In the following section we discuss more practical aspects of based on the modeling concepts presented in Sect. “**Modeling**”. Tools of different sophistication have been developed that are nowadays routinely used in safety analysis. The latter becomes more and more relevant since many public facilities must fulfill certain legal standards. As an example we mention aircrafts which must be evacuated within 90 seconds. The simulations etc. are already used in the planning stages because changes of the design at a later stage are difficult and expensive.

For this kind of safety analysis tools of different sophistication have been developed. Some of them mainly are able to predict just evacuation times whereas others are based on microscopic simulations which allow also to study various external influences (fire, smoke, ...) in much detail.

## Calculation of Evacuation Times

The basic idea of hand calculation methods has already briefly been described at the end of Subsect. “**Fluid-Dynamic and Gas Kinetic Models**”. Here we want to discuss its practical aspects in more detail.

The approach has been developed since the middle of the 1950s [185]. The basic idea of these methods is the assumption that people can be modeled to behave like fluids. Knowledge of the flow (see Eq. 1) and the technical data of the facility are then sufficient to evaluate evacuation times, etc.

Hand calculation method can be divided into two major approaches: methods with “dynamic” flow [35,42,78,79,80,136,151,152,163,192] and methods with “fixed” flow [110,123,124,125,126,137,145,173,185]. As methods

with “dynamic” flow we cite methods where the pedestrian flow is dependent on the density of the pedestrian stream (see Subsect. “**Observables**”) in the selected facility, thus the flow can be obtained from fundamental diagrams (see Subsect. “**Fundamental Diagram**”) or it is explicitly prescribed in the chosen method. This flow can change during movement through the building, e. g., by using stairs, thus the pedestrian stream has a “dynamic” flow. Methods with “fixed” flow do not use this concept of relationship between density and flow. In these methods selected facilities (e. g., stairs or doors) have a fixed flow which is independent from the density, which is usually not used in these methods. The “fixed” flow is usually based upon empirical and measured data of flow, which are specified for a special type of building, such as high-rise buildings or railway stations, for example. Because of much simplification, in these “fixed” flow methods a calculation can always be done very quickly.

Methods with “dynamic” flow allow one to describe the condition of the pedestrian flow in every part of a selected building or environment, because they are mostly based upon the continuity equation, thus it is possible to calculate different kinds of buildings. This allows the user to calculate transitions from wide to narrow, floor to door, floor to stair, etc. The disadvantage is that some these methods are very elaborate and time-intensive. But in general, a method with “dynamic” flow is not complicated to calculate, thus we want to divide hand calculation methods in simple [35,42,110,123,124,125,126,136,137,145,152,163,173,185,192] and complex [78,79,80,151] for evacuation calculation. All of these hand calculation methods are able to predict total evacuation times for a selected building, but differences between different methods still exist. Thus the user has to ensure that he is familiar with assumptions made by each method to ensure that a result is interpreted in a correct way [161].

## Simulation of Evacuation Processes

Before we go into the details of evacuation simulation, let us briefly clarify its scope and limitations and contrast it to other methods used in evacuation analysis. When analyzing evacuation processes, three different approaches can be identified:

- (1) Risk assessment,
- (2) Optimization, and
- (3) Simulation.

The aim and result of risk-assessment is a list of events and their consequences (e. g., damage, financial loss, loss of life), i. e., usually an event tree with probabilities and

expectation values for financial loss. Optimization aims at, roughly speaking, minimizing the evacuation time and reducing the area and duration of congestion. And finally, simulation describes a system with respect to its function and behavior by investigating a model of the system. This model is usually non-analytic, so does not provide explicit equations for the calculation of, e. g., evacuation time. Of course, simulations are used for “optimization” in a more general sense, too, i. e., they can be part of an optimization. This holds for risk assessment, too, if simulations are used to determine the outcomes of the different scenarios in the event tree.

In evacuation analysis the system is, generally speaking, a group of persons in an environment. More specifically, four components (sub-systems/sub-models) of the system *evacuation process* can be identified:

- (1) Geometry,
- (2) Environment,
- (3) Population, and
- (4) Hazards [43].

Any evacuation simulation must at least take into account (1) and (3). The behavior of the persons (which can be described on the strategic, tactical, and operational level—see Sect. “**Modeling**”) is part of the population sub-model. An alternative way of describing behavior is according to its algorithmic representation: no behavior modeling – functional analogy – implicit representation (equation) – rule based – artificial intelligence [43].

In the context of evacuation, hazards are first of all fire and smoke, which then require a toxicity sub-model, e. g., the fractional effective dose model (FED), to assess the physiological effect of toxic gases and temperature [25]. Further hazards to take into account might be earthquakes, flooding, or in the case of ships, list, heel, or roll motion. The sub-model environment comprises all other influences that affect the evacuation process, e. g., exit signs, surface texture, public address system, etc.

In summary, aims of an evacuation analysis and simulation are to provide feedback and hints for improvement at an early stage of design, information for safer and more rigorous regulations, improvement of emergency preparedness, training of staff, and accident investigation [43]. They usually do not provide direct results on the probability of a scenario or a systematic search for optimal geometries.

**Calculation of Overall Evacuation Time, Identification of Congestion, and Corrective Actions** The scope of this section is to show general results that can be obtained by evacuation simulations. They are general in the sense

that they can basically be obtained by any stochastic and microscopic model, i. e., apart from these two requirements, the results are not model specific. In detail, five different results of evacuation simulations can be distinguished:

- (1) Distribution of evacuation times,
- (2) Evacuation curve (number of persons evacuated vs. time),
- (3) Sequence of the evacuation (e. g., snapshots/screenshots at specific times, e. g., every minute), and
- (4) Identification of congestion, usually based on density and time.

The last point (4), in particular, needs some more explanation: congestion is defined based on density. Notwithstanding the difficulties of measuring density, we suggest density as the most suitable criterion for the identification of congestion. In addition to the mere occurrence of densities exceeding a certain threshold (say 3.5 persons per square meter), the time this threshold is exceeded is another necessary condition for a sensible definition of congestion. In the case presented here, 10% of the overall evacuation time is used. Both criteria are in accordance with the IMO regulations [118].

Based on these results, evacuation time and areas of congestion, corrective actions can be taken. The most straightforward measure would be a change of geometry, i. e., shorter or wider escape paths (floors, stairs, doors). This can be directly put into the geometry sub-model, the simulation can be re-run, and the result checked. Secondly, the signage, and therefore the orientation capability, can be improved. This is not as straightforward as geometrical changes. It does depend more heavily on the model characteristics as to how these changes influence the evacuation sequence.

We will not go into these details in the following two sections but rather show two typical examples for evacuation simulations and the results obtained. We will also not discuss the results in detail, since they are of an illustrative nature in the context of this article. The following examples are based on investigations that have been performed using a cellular automaton model which is described along with the simulation program in [90,111].

**Simulation Example 1 – Hotel** The first example we show is a hotel with 8069 persons. In Fig. 15 only the ground floor is shown. There are nine floors altogether. The upper floors influence the ground floor only via the stair landings and the exits adjacent to them. Most of the 8069 persons are initially located in the ground floor, since the theater and conference area is located there. The upper



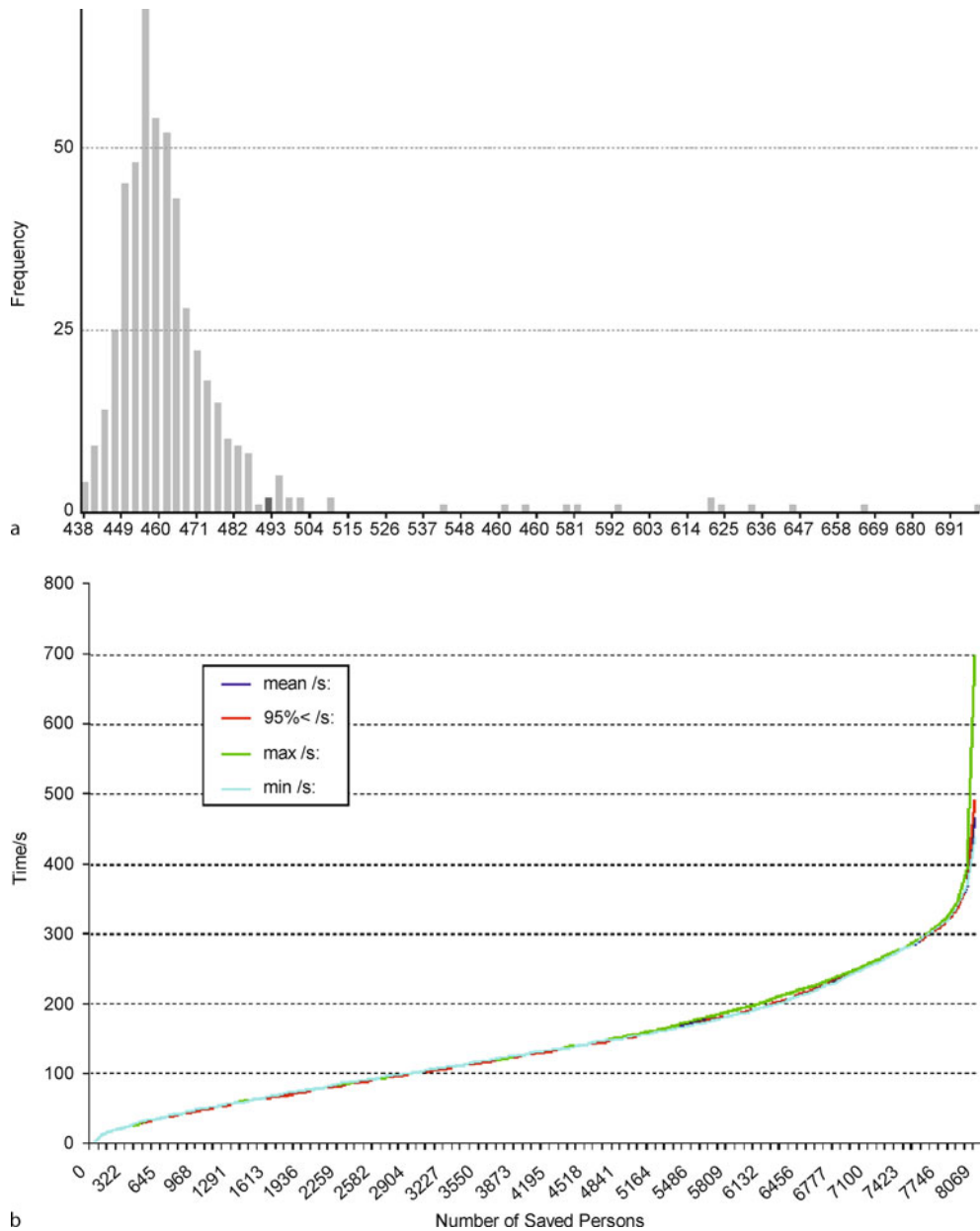

Evacuation Dynamics: Empirical Results, Modeling and Applications, Figure 14  
 Frequency distribution for the overall evacuation time (a) and evacuation curve (b)

floors are mainly covering bedrooms and some small conference areas.

The first step in our example (which might well be a useful recipe for evacuation analyses in general and is again in accordance with [118]) is to perform a statistical analysis. To this end, 500 samples are simulated. The evacuation time of a single run is the time it takes for all persons to get out. In this context, no fire or smoke are

taken into account. Since there are stochastic influences in the model used, the significant overall evacuation time is taken to be the 95-percentile (cf. Fig. 14). Finally, the maximum, minimum, mean, and significant values for the evacuation curve (number of persons evacuated vs. time) are also shown in Fig. 14.

The next figure (Fig. 16) shows the cumulated density. The thresholds (red areas) are 3.5 persons per square me-



a

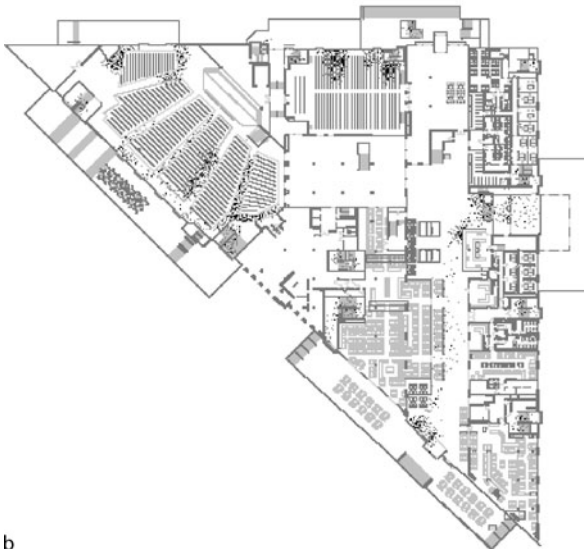

b

Evacuation Dynamics: Empirical Results, Modeling and Applications, Figure 15

Initial population distribution and situation after two minutes

ter and 10% of the overall evacuation time (in this case 49 seconds). The overall evacuation time is 8:13 minutes (493 seconds). This value is obtained by taking the 95-percentile of the frequency distribution for the overall evacuation times (cf. Fig. 14).

Of course, a distribution of overall evacuation times (for one scenario, i.e., the same initial parameters) can only be obtained by a stochastic model. In a deterministic model only one single value is calculated for the overall evacuation time. The variance of the overall evacuation

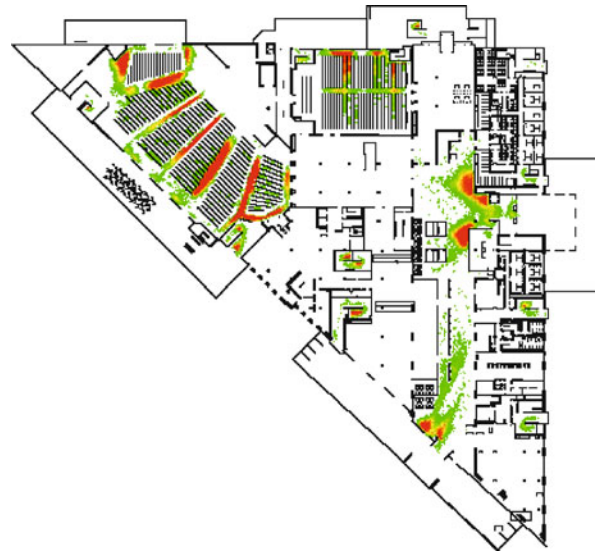

Evacuation Dynamics: Empirical Results, Modeling and Applications, Figure 16

Density plot, i.e., cumulated person density exceeding 3.5 persons per square meter and 10% of overall evacuation time

times is due to two effects in the model used here: the initial position of the persons is determined anew at the beginning of each simulation run since only the statistical properties of the overall population are set and the motion of the persons is governed by partially stochastic rules (e.g., probabilistic parameters).

**Simulation Example 2 – Passenger Ship** The second example we will show is a ship. The major difference from the previous example is the addition of (1) the assembly phase and (2) embarkation and launching.

$$\begin{aligned}
 T &= A + \frac{2}{3}(E + L) \\
 &= f_{\text{safety}} \cdot (t_{\text{react}} + t_{\text{walk}}) + \frac{2}{3}(E + L) \\
 &\leq 60 \text{ minutes} .
 \end{aligned}$$

Embarkation and launching time ( $E + L$ ) are required to be less than 30 minutes. For the sake of the evacuation analysis at an early design stage, the sum of embarkation and launching time can be assumed to be 30 minutes. Therefore, the requirement for  $A$  is 40 minutes. Alternatively, the embarkation and launching time can be determined by an evacuation trial.

Figure 17 shows the layout, initial population distribution (night case), density plot for the day case, and density plot for the night case. The reaction times are different for the day and the night case: 3 to 7 minutes (equally distributed) in the one and 7 to 13 minutes in the other. The

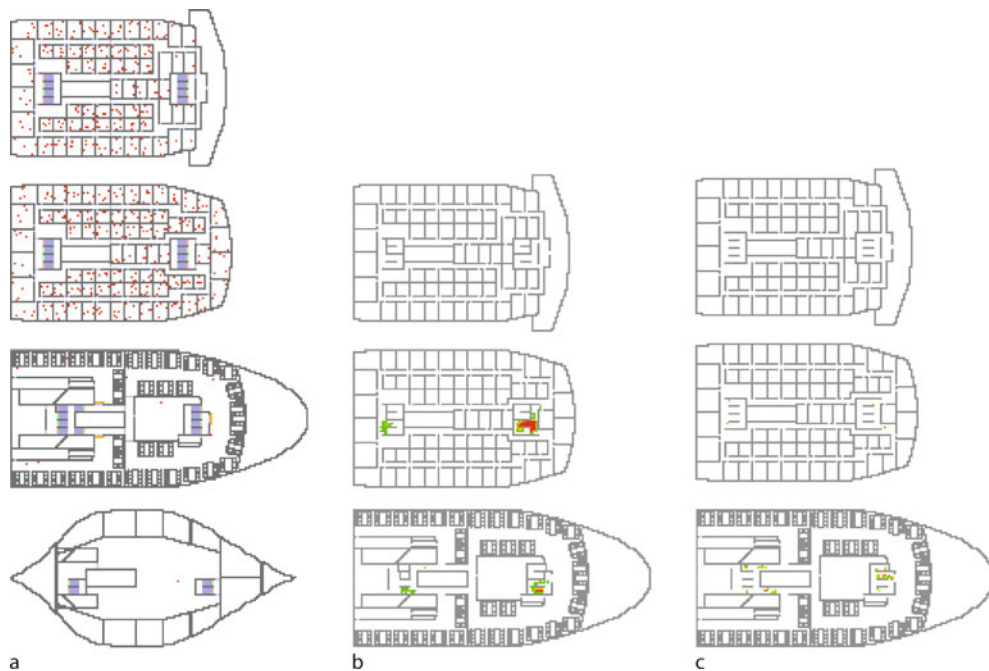

Evacuation Dynamics: Empirical Results, Modeling and Applications, Figure 17

Initial distribution for the night case, density plot for the day case, and density plot for the night case for the "AENEAS steamliner"

longer reaction time in the night case results in less congestion (cf. Fig. 17). Both cases must be done in the analysis according to [118]. Additionally, a secondary night and day case are required (making up four cases altogether). In these secondary cases the main vertical zone (MVZ) leading to the longest overall individual assembly time is identified, and then either half of the stairway capacity in this zone is assumed to be not available, or 50% of the persons initially located in this zone must be led via one neighboring zone to the assembly station.

In the same way as shown for the two examples, simulations can be performed for other types of buildings and vessels. This technique has been applied to various passenger ships [112] to football stadiums [88] and the World Youth Day 2005 [88], the Jamarat Bridge in Makkah [88], a movie theater and schools (mainly for calibration and validation) [90] and airports [171]. Of course, many examples of applications based on various models can be found in the literature. For an overview, the proceedings of the PED conference series are an excellent starting point [44, 170, 190].

### Comparison of Commercial Software Tools

From a practical point of view, application of models for pedestrian dynamics and evacuation processes becomes

more and more relevant in safety analysis. This has led to the development of a number of software tools that, with different sophistication, help us study many aspects without risking the health of test persons in evacuation trials.

There are commercial, as well as non-commercial software tools. All tools might be based on different models [97, 187]. They have become very popular since the middle of the 1990s. A first comparison of different commercial software tools can be found in [191], where they were said to produce "reasonable results". Further comparisons of real evacuation data with software tools or hand calculation methods can be found in [29, 67, 91, 96, 104, 160, 161, 177]. But results predicted by different commercial software tools can differ by up to 40% for the same building [96]. Results may differ, too, when calculating with different assumptions, e.g., different reaction times, use of more or less detailed stair models, or when calculating with a real occupant load in contrast to an uncertainty analysis [96, 104]. Contrary to these results, another study [161] shows that calculations with different software tools are able to predict total evacuation times for high-rise buildings and there are no large differences as shown in [96]. In [161] the results of an evacuation trial and simulations with different commercial software tools differed for selected floors of a highrise building. The den-

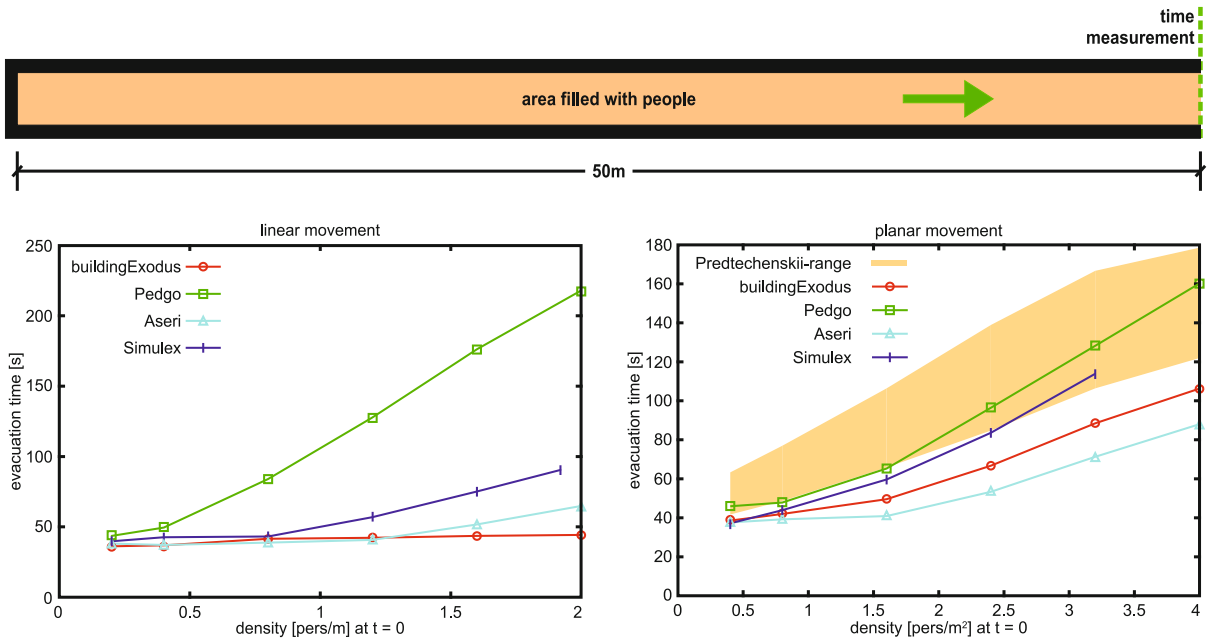

Evacuation Dynamics: Empirical Results, Modeling and Applications, Figure 18

Comparison of different software tools by simulating linear (*left*, narrow floor) and planar (*right*, 2 m wide floor) movement [162]

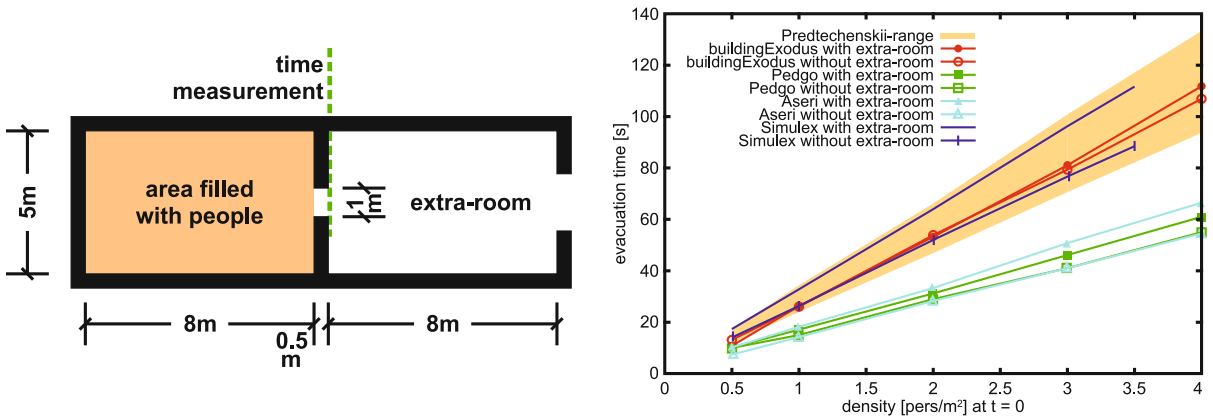

Evacuation Dynamics: Empirical Results, Modeling and Applications, Figure 19

Comparison of different software tools by simulating a simple room geometry [162]

sities were very low in this instance. In this case human behavior has a very large influence on the evacuation time. By contrast, evacuations at medium or high densities, human behavior has a smaller influence on the evacuation time of selected areas because congestion appears and continues larger than in low density situations – thus people reach the exit while congestion is still a factor [162]. In low density situations congestions are very rare, thus people move narrowly with free walking velocity through the building [162].

But the results presented in [161] also show that commercial software tools sometimes have problems with the empirical relationship of density and walking speed (see Fig. 18). Furthermore, it is very important how boundary conditions are implemented in these tools (see Fig. 19), and the investigation of a simple scenario of a single room using different software tools shows results differing by about a factor of two (see Fig. 19) [161]. In this case all software tools predict a congestion at the exit. Furthermore it is possible that the implemented algorithm fails [161].

Thus for the user it is hard to know which algorithms are implemented in closed-source tools so that such a tool must be considered as “black box” [147]. It is also quite difficult to compare results about density and appearing congestions calculated by different software tools [162] and so it is questionable how these results should be interpreted. But, as pointed out earlier, reliable empirical data are often missing so that a validation of software tools or models is quite difficult [162].

### Future Directions

The discussion has shown that the problem of crowd dynamics and evacuation processes is far from being well understood. One big problem is experimental basis. As in many human systems, it is difficult to perform controlled experiments on a sufficiently large scale. This would be necessary since data from actual emergency situations is usually not available, at least in sufficient quality. Progress should be possible by using modern video and computer technology which should allow us, in principle, to extract precise data even for the trajectories of individuals.

The full understanding of the complex dynamics of evacuation processes requires collaboration between engineering, physics, computer science, psychology, etc. Engineering in cooperation with computer science will lead to an improved empirical basis. Methods from physics allow us to develop simple but realistic models that capture the main aspects of the dynamics. Psychology is then needed to understand the interactions between individuals in sufficient detail to get a reliable set of ‘interaction’ parameters for the physical models.

In the end, we hope these joint efforts will lead to realistic models for evacuation processes that not only allow us to study these in the planning stages of facilities, but even allow for dynamical real-time evacuation control in case an emergency occurs.

### Acknowledgments

The authors would like to acknowledge the contribution of Tim Meyer-König (the developer of PedGo) and Michael Schreckenberg, Ansgar Kirchner, Bernhard Steffen for many fruitful discussions and valuable hints.

### Bibliography

#### Primary Literature

- Abe K (1986) *The Science of Human Panic*. Brain, Tokyo (in Japanese)
- AlGadhi SAH, Mahmassani HS, Herman R (2002) A speed-concentration relation for bi-directional crowd movements with strong interaction. In: Schreckenberg M, Sharma SD (eds) *Pedestrian and Evacuation Dynamics*. Springer, Berlin, pp 3–20
- American Sociological Association (2002) *In disasters, panic is rare, altruism dominates*. Technical report, American Sociological Association
- Ashe B, Shields TJ (1999) Analysis and modelling of the unannounced evacuation of a large retail store. *Fire Mater* 23: 333–336
- Ben-Jacob E (1997) From snowflake formation to growth of bacterial colonies, Part II. Cooperative formation of complex colonial patterns. *Contemp Phys* 38:205
- Biham O, Middleton AA, Levine D (1992) Self-organization and a dynamical transition in traffic-flow models. *Phys Rev A* 46:R6124
- Blue VJ, Adler JL (2000) Cellular automata microsimulation of bi-directional pedestrian flows. *J Trans Res Board* 1678: 135–141
- Blue VJ, Adler JL (2002) Flow capacities from cellular automata modeling of proportional spills of pedestrians by direction. In: Schreckenberg M, Sharma SD (eds) *Pedestrian and Evacuation Dynamics*. Springer, Berlin, pp 115–121
- Blythe RA et al (2007) Nonequilibrium steady states of matrix product form: a solver’s guide. *Math Theor* 40:R333–R441, doi:10.1088/1751-8113/40/46/R01
- Bolay K (1998) *Nichtlineare Phänomene in einem fluid-dynamischen Verkehrsmodell*. Diploma Thesis, Stuttgart University
- Boyce KE, Shields TJ, Silcock GWH (1999) Toward the Characterization of Building Occupancies for Fire Safety Engineering: Capabilities of Disabled People Moving Horizontally and on an Incline. *Fire Technol* 35:51–67
- Bryan JL (1995) Behavioral response to fire and smoke. In: DiNenno PJ, Beyler CL, Custer RLP, Walton WD, Watts JM, Drysdale D, Hall JR (eds) *SFPE Handbook of Fire Protection Engineering*, 2nd edn. National Fire Protection Association, Quincy, p 263
- Burstedde C, Klauck K, Schadschneider A, Zittartz J (2001) Simulation of pedestrian dynamics using a two-dimensional cellular automaton. *Physica A* 295:507–525
- Burstedde C, Kirchner A, Klauck K, Schadschneider A, Zittartz J (2002) Cellular automaton approach to pedestrian dynamics – applications. In: Schreckenberg M, Sharma SD (eds) *Pedestrian and Evacuation Dynamics*. Springer, Berlin, pp 87–98
- Chakrabarti J, Dzubiella J, Löwen H (2004) Reentrance effect in the lane formation of driven colloids. *Phys Rev E* 70:012401
- Chowdhury D, Santen L, Schadschneider A (2000) Statistical physics of vehicular traffic and some related systems. *Phys Rep* 329(4–6):199–329
- Clarke L (2002) Panic: Myth or reality? *Contexts* 1(3):21–26
- Coleman JS (1990) *Foundation of Social Theory*. Belknap, Cambridge, Chap 9
- Daamen W (2004) *Modelling Passenger Flows in Public Transport Facilities*. Ph.D. thesis, Technical University of Delft
- Daamen W, Hoogendoorn SP (2006) Flow-density relations for pedestrian traffic. In: Schadschneider A, Pöschel T, Kühne R, Schreckenberg M, Wolf DE (eds) *Traffic and Granular Flow 05*. Springer, Berlin, pp 315–322
- Daamen W, Bovy PHL, Hoogendoorn SP (2002) Modelling pedestrians in transfer stations. In: Schreckenberg M, Sharma SD (eds) *Pedestrian and Evacuation Dynamics*. Springer, Berlin, pp 3–20

- SD (eds) *Pedestrian and Evacuation Dynamics*. Springer, Berlin, pp 59–73
22. de Gelder B, Snyder J, Greve D, Gerard G, Hadjikhani N (2004) Fear fosters flight: A mechanism for fear contagion when perceiving emotion expressed by a whole body. *Proc Natl Acad Sci* 101(47):16701–16706
  23. Derrida B (1998) An exactly soluble non-equilibrium system: The asymmetric simple exclusion process. *Phys Rep* 301:65
  24. Dieckmann D (1911) *Die Feuersicherheit in Theatern*. Jung, München (in German)
  25. DiNenno PJ (ed) (2002) *SFPE Handbook of Fire Protection Engineering*, 3rd edn. National Fire Protection Association, Bethesda
  26. DiNenno PJ, Beyler CL, Custer RLP, Walton WD, Watts JM, Drysdale D, Hall JR (eds) (1995) *SFPE Handbook of Fire Protection Engineering*, 2nd edn. National Fire Protection Association, Quincy
  27. Dogliani M (2002) An overview of present and under-development IMO's requirements concerning evacuation from ships. In: Schreckenberg M, Sharma SD (eds) *Pedestrian and Evacuation Dynamics*. Springer, Berlin, pp 339–354
  28. Dzubiella J, Hoffmann GP, Löwen H (2002) Lane formation in colloidal mixtures driven by an external field. *Phys Rev E* 65:021402
  29. Ehm M, Linxweiler J (2004) Berechnungen von Evakuierungszeiten bei Sonderbauten mit dem Programm buildingExodus. Technical report, TU Braunschweig
  30. El Yacoubi S, Chopard B, Bandini S (eds) (2006) *Cellular Automata – 7th International Conference on Cellular Automata for Research and Industry, ACRI 2006*, Perpignan. Springer, Berlin
  31. Federal Aviation Administration FAA (1990) Emergency evacuation – cfr sec. 25.803. Regulation CFR Sec. 25.803
  32. Fischer H (1933) *Über die Leistungsfähigkeit von Türen, Gängen und Treppen bei ruhigem, dichtem Verkehr*. Dissertation, Technische Hochschule Dresden (in German)
  33. Frantzych H (1996) Study of movement on stairs during evacuation using video analysing techniques. Technical report, Department of Fire Safety Engineering, Lund Institute of Technology
  34. Frisch U, Hasslacher B, Pomeau Y (1986) Lattice-gas automata for the Navier-Stokes equation. *Phys Rev Lett* 56:1505
  35. Fruin JJ (1971) *Pedestrian Planning and Design*. Metropolitan Association of Urban Designers and Environmental Planners, New York
  36. Fruin JJ (1993) The causes and prevention of crowd disasters. In: Smith RA, Dickie JF (eds) *Engineering for Crowd Safety*. Amsterdam, Elsevier
  37. Fujiyama T (2006) Collision avoidance of pedestrians on stairs. Technical report, Centre for Transport Studies. University College London, London
  38. Fujiyama T, Tyler N (2004) An explicit study on walking speeds of pedestrians on stairs. In: 10th International Conference on Mobility and Transport for Elderly and Disabled People, Hamamatsu, Japan, May 2004
  39. Fujiyama T, Tyler N (2004) Pedestrian Speeds on Stairs: An Initial Step for a Simulation Model. In: Proceedings of 36th Universities Transport Studies Group Conference, Life Science Centre, Newcastle upon Tyne, Jan 2004
  40. Fukui M, Ishibashi Y (1999) Jamming transition in cellular automaton models for pedestrians on passageway. *J Phys Soc Jpn* 68:3738
  41. Fukui M, Ishibashi Y (1999) Self-organized phase transitions in cellular automaton models for pedestrians. *J Phys Soc Jpn* 68:2861
  42. Galbreath M (1969) Time of evacuation by stairs in high buildings. *Fire Res Note* 8, NRCC
  43. Galea ER (2002) Simulating evacuation and circulation in planes, trains, buildings and ships using the EXODUS software. In: Schreckenberg M, Sharma SD (eds) *Pedestrian and Evacuation Dynamics*. Springer, Berlin pp 203–226
  44. Galea ER (ed) (2003) *Pedestrian and Evacuation Dynamics 2003*. CMS Press, London
  45. Gipps PG, Marksjö B (1985) A micro-simulation model for pedestrian flows. *Math Comput Simul* 27:95–105
  46. Graat E, Midden C, Bockholts P (1999) Complex evacuation; effects of motivation level and slope of stairs on emergency egress time in a sports stadium. *Saf Sci* 31:127–141
  47. Grosshandler W, Sunder S, Snell J (2003) Building and fire safety investigation of the world trade center disaster. In: Galea ER (ed) *Pedestrian and Evacuation Dynamics 2003*. CMS Press, London, pp 279–281
  48. Hamacher HW, Tjandra SA (2002) Mathematical modelling of evacuation problems – a state of the art. In: Schreckenberg M, Sharma SD (eds) *Pedestrian and Evacuation Dynamics*. Springer, Berlin, pp 227–266
  49. Hankin BD, Wright RA (1958) Passenger flow in subways. *Oper Res Q* 9:81–88
  50. Helbing D (1992) A fluid-dynamic model for the movement of pedestrians. *Complex Syst* 6:391–415
  51. Helbing D (2001) Traffic and related self-driven many-particle systems. *Rev Mod Phys* 73:1067–1141
  52. Helbing D, Molnár P (1995) Social force model for pedestrian dynamics. *Phys Rev E* 51:4282–4286
  53. Helbing D, Farkas I, Vicsek T (2000) Freezing by heating in a driven mesoscopic system. *Phys Rev Lett* 84:1240–1243
  54. Helbing D, Farkas I, Vicsek T (2000) Simulating dynamical features of escape panic. *Nature* 407:487–490
  55. Helbing D, Farkas I, Molnár P, Vicsek T (2002) Simulation of pedestrian crowds in normal and evacuation situations. In: Schreckenberg M, Sharma SD (eds) *Pedestrian and Evacuation Dynamics*. Springer, Berlin, pp 21–58
  56. Helbing D, Buzna L, Werner T (2003) Self-organized pedestrian crowd dynamics and design solutions. *Traffic Forum*, pp 2003-12
  57. Helbing D, Buzna L, Johansson A, Werner T (2005) Self-organized pedestrian crowd dynamics: Experiments, simulations, and design solutions. *Transp Sci* 39:1–24
  58. Helbing D, Johansson A, Al-Abideen HZ (2007) The dynamics of crowd disasters: An empirical study. *Phys Rev E* 75:046109
  59. Helbing D, Johansson A, Al-Abideen HZ (2007) Crowd turbulence: the physics of crowd disasters. In: The Fifth International Conference on Nonlinear Mechanics, ICNM-V, Shanghai, pp 967–969
  60. Henderson LF (1971) The statistics of crowd fluids. *Nature* 229:381–383
  61. Henderson LF (1974) On the fluid mechanics of human crowd motion. *Transp Res* 8:509–515
  62. Hoogendoorn SP (2003) Walker behaviour modelling by differential games. In: Emmerich H, Nestler B, Schreckenberg M

- (eds) Interface and transport dynamics. Lecture notes in Computational Science and Engineering, vol 32. Springer, Berlin, pp 275–294
63. Hoogendoorn SP, Bovy PHL (2003) Simulation of pedestrian flows by optimal control and differential games. *Optim Control Appl Meth* 24:153
  64. Hoogendoorn SP, Daamen W (2005) Pedestrian behavior at bottlenecks. *Transp Sci* 39 2:0147–0159
  65. Hoogendoorn SP, Bovy PHL, Daamen W (2002) Microscopic pedestrian wayfinding and dynamics modelling. In: Schreckenberg M, Sharma SD (eds) *Pedestrian and Evacuation Dynamics*. Springer, Berlin, pp 123–154
  66. Hoogendoorn SP, Daamen W, Bovy PHL (2003) Microscopic pedestrian traffic data collection and analysis by walking experiments: Behaviour at bottlenecks. In: Galea ER (ed) *Pedestrian and Evacuation Dynamics 2003*. CMS Press, London, pp 89–100
  67. Hoskin K (2004) Fire protection and evacuation procedures of stadia venues in new zealand. Master's thesis, University of Canterbury
  68. Hughes RL (2000) The flow of large crowds of pedestrians. *Math Comput Simul* 53:367–370
  69. Hughes RL (2002) A continuum theory for the flow of pedestrians. *Transp Res Part B* 36:507–535
  70. International Maritime Organization (IMO) (2000) International Code of Safety for High-Speed Craft, 2000 (2000 HSC Code). Technical report, Resolution MSC 97(73)
  71. International Organization for Standardization (2000) ISO-TR-13387-8-1999 Fire safety engineering – part 8: Life safety – occupant behaviour, location and condition. Technical report
  72. Jian L, Lizhong Y, Daoling Z (2005) Simulation of bi-direction pedestrian movement in corridor. *Physica A* 354:619
  73. Johnson NR (1987) Panic at “The Who Concert Stampede”: An Empirical Assessment. *Soc Probl* 34(4):362–373
  74. Jungermann H, Göhlert C (2000) Emergency evacuation from double-deck aircraft. In: Cottam MP, Harvey DW, Pape RP, Tait J (eds) *Foresight and Precaution*. Proceedings of ESREL 2000, SARS and SRA. Europe Annual Conference, Rotterdam, pp 989–992
  75. Kashiwagi T (ed) (1994) *Fire Safety Science – 4th international Symposium Proceedings*. Interscience, West Yard House, Guildford. The International Association for Fire Safety Science. Grove, London
  76. Kaufman M (2007) Lane Formation in Counterflow Situations of Pedestrian Traffic. Master's thesis, Universität Duisburg-Essen
  77. Keating JP (1982) The myth of panic. *Fire J* May:57–62
  78. Kendik E (1983) Determination of the evacuation time pertinent to the projected area factor in the event of total evacuation of high-rise office buildings via staircases. *Fire Saf J* 5:223–232
  79. Kendik E (1984) Die Berechnung der Personenströme als Grundlage für die Bemessung von Gehwegen in Gebäuden und um Gebäude. Ph.D. thesis, TU Wien
  80. Kendik E (1986) Designing escape routes in buildings. *Fire Technol* 22:272–294
  81. Kerner BS (2004) *The Physics of Traffic*. Springer, Heidelberg
  82. Kirchner A (2003) Modellierung und statistische Physik biologischer und sozialer Systeme. Dissertation, Universität zu Köln
  83. Kirchner A, Schadschneider A (2002) Simulation of evacuation processes using a bionics-inspired cellular automaton model for pedestrian dynamics. *Physica A* 312:260–276
  84. Kirchner A, Namazi A, Nishinari K, Schadschneider A (2003) Role of conflicts in the floor field cellular automaton model for pedestrian dynamics. In: Galea ER (ed) *Pedestrian and Evacuation Dynamics 2003*. CMS Press, London, pp 51
  85. Kirchner A, Nishinari K, Schadschneider A (2003) Friction effects and clogging in a cellular automaton model for pedestrian dynamics. *Phys Rev E* 67:056122
  86. Kirchner A, Klüpfel H, Nishinari K, Schadschneider A, Schreckenberg M (2004) Discretization effects and the influence of walking speed in cellular automata models for pedestrian dynamics. *J Stat Mech* 10:P10011
  87. Klüpfel H (2003) A Cellular Automaton Model for Crowd Movement and Egress Simulation. Dissertation, University Duisburg-Essen
  88. Klüpfel H (2006) The simulation of crowds at very large events. In: Schadschneider A, Pöschel T, Kühne R, Schreckenberg M, Wolf DE (eds) *Traffic and Granular Flow 05*. Springer, Berlin, pp 341–346
  89. Klüpfel H, Meyer-König T, Wahle J, Schreckenberg M (2000) Microscopic simulation of evacuation processes on passenger ships. In: Bandini S, Worsch T (eds) *Theory and Practical Issues on Cellular Automata*. Springer, Berlin
  90. Klüpfel H, Meyer-König T, Schreckenberg M (2001) Empirical data on an evacuation exercise in a movie theater. Technical report, University Duisburg-Essen
  91. Ko SY (2003) Comparison of evacuation times using Simulex and EvacuationNZ based on trial evacuations. Fire Engineering Research Report 03/9, University of Canterbury
  92. Kretz T (2007) Pedestrian Traffic – Simulation and Experiments. Dissertation, Universität Duisburg-Essen
  93. Kretz T, Grünebohm A, Schreckenberg M (2006) Experimental study of pedestrian flow through a bottleneck. *J Stat Mech* P10014
  94. Kretz T, Grünebohm A, Kaufmann M, Mazur F, Schreckenberg M (2006) Experimental study of pedestrian counterflow in a corridor. *J Stat Mech* P10001
  95. Kretz T, Grünebohm A, Keßel A, Klüpfel H, Meyer-König T, Schreckenberg M (2008) Upstairs walking speed distributions on a long stair. *Saf Sci* 46:72–78
  96. Kuligowski ED, Milke JA (2005) A performance-based egress analysis of a hotel building using two models. *J Fire Prot Eng* 15:287–305
  97. Kuligowski ED, Peacock RD (2005) A review of building evacuation models. Technical report 1471. National Institute of Standards and Technology, Gaithersburg
  98. Lakoba TI, Kaup DJ, Finkelstein NM (2005) Modifications of the Helbing-Molnár-Farkas-Vicsek social force model for pedestrian evolution. *Simulation* 81(5):339–352
  99. Lam WHK, Lee JYS, Chan KS, Goh PK (2003) A generalised function for modeling bi-directional flow effects on indoor walkways in Hong Kong. *Transp Res A: Policy Pract* 37:789–810
  100. Laur U, Jaakula H, Metsaveer J, Lehtola K, Livonen H, Karpinen T, Eksborg AL, Rosengren H, Noord O (1997) Final Report on the Capsizing on 28 September 1994 in the Baltic Sea of the Ro-Ro Passenger Vessel MV Estonia. Technical report. The Joint Accident Investigation Commission of Estonia, Finland and Sweden

101. LeBon G (1895) *Lois Psychologiques De L'évolution Des Peuples*. Alcan, Paris
102. Leutzbach W (1988) *Introduction to the Theory of Traffic Flow*. Springer, Berlin
103. Lewin K (1951) *Field Theory in Social Science*. Harper, New York
104. Lord J, Meacham B, Moore A, Fahy R, Proulx G (2005) *Guide for evaluating the predictive capabilities of computer egress models*. Technical report NIST GCR 06-886, NIST, Gaithersburg
105. Lovas GG (1994) Modeling and simulation of pedestrian traffic flow. *Transp Res B* 28V:429
106. Maniccam S (2003) Traffic jamming on hexagonal lattice. *Physica A* 321:653
107. Maniccam S (2005) Effects of back step and update rule on congestion of mobile objects. *Physica A* 346:631
108. Marconi S, Chopard B (2002) A multiparticle lattice gas automata model for a crowd. In: *Cellular Automata. Lecture Notes Computer Science*, vol 2493. Springer, Berlin, pp 231
109. Mawson AR (2005) Understanding mass panic and other collective responses to threat and disaster. *Psychiatry* 68:95-113
110. Melinek SJ, Booth S (1975) An analysis of evacuation times and the movement of crowds in buildings. Technical report CP 96/75, BRE
111. Meyer-König T, Klüpfel H, Schreckenberg M (2001) A microscopic model for simulating mustering and evacuation processes onboard passenger ships. In: KH Dräger (ed) *Proceedings of the International Emergency Management Society Conference. The International Emergency Management Society, Oslo*
112. Meyer-König T, Klüpfel H, Schreckenberg M (2002) Assessment and analysis of evacuation processes on passenger ships by microscopic simulation. In: Schreckenberg M, Sharma SD (eds) *Pedestrian and Evacuation Dynamics*. Springer, Berlin, pp 297-302
113. Mintz A (1951) Non-adaptive group behaviour. *J Abnorm Soc Psychol* 46:150-159
114. Molnár P (1995) *Modellierung und Simulation der Dynamik von Fußgängerströmen*. Dissertation, Universität Stuttgart
115. Mori M, Tsukaguchi H (1987) A new method for evaluation of level of service in pedestrian facilities. *Transp Res* 21A(3): 223-234
116. Morrall JF, Ratnayake LL, Seneviratne PN (1991) Comparison of CBD pedestrian characteristics in Canada and Sri Lanka. In: *Transportation Research Record 1294*. TRB, National Research Council, Washington DC, pp 57-61
117. MSA (1997) *Report on Exercise Invicta*. Technical report. Marine Safety Agency, Southampton
118. MSC-Circ.1033. *Interim guidelines for evacuation analyses for new and existing passenger ships*. Technical report, International Maritime Organization, Marine Safety Committee, London, June, 6th 2002. MSC/Circ. 1033
119. MSC-Circ.1166. *Guidelines for a simplified evacuation analysis for high-speed passenger craft*. Technical report, International Maritime Organisation, 2005
120. Muir HC (1997) *Airplane of the 21st century: Challenges in safety and survivability*. International Conference on Aviation Safety and Security in the 21st Century, White House Commission on Aviation Safety and Security, Washington
121. Muir HC, Bottomley DM, Marrison C (1996) Effects of motivation and cabin configuration on emergency aircraft evacuation behavior and rates of egress. *Int J Aviat Psychol* 6(1):57-77
122. Müller K (1981) *Zur Gestaltung und Bemessung von Fluchtwegen für die Evakuierung von Personen aus Bauwerken auf der Grundlage von Modellversuchen*. Dissertation, Technische Hochschule Magdeburg
123. Müller W (1966) Die Beurteilung von Treppen als Rückzugsweg in mehrgeschossigen Gebäuden. *Unser Brandschutz – Wissenschaftlich-Technische Beil* 3:65-70; to be continued in 4/1966
124. Müller W (1966) Die Beurteilung von Treppen als Rückzugsweg in mehrgeschossigen Gebäuden. *Unser Brandschutz – Wissenschaftlich-Technische Beil* 4:93-96; continuation from 3/1966
125. Müller W (1968) Die Überschneidung der Verkehrsströme bei dem Berechnen der Räumungszeit von Gebäuden. *Unser Brandschutz – Wissenschaftlich-Technische Beil* 4:87-92
126. Müller W (1970) *Untersuchung über zulässige Räumungszeiten und die Bemessung von Rückzugswegen in Gebäuden*. Habilitation, TU Dresden, Dresden
127. Muramatsu M, Nagatani T (2000) Jamming transition in two-dimensional pedestrian traffic. *Physica A* 275:281-291
128. Muramatsu M, Nagatani T (2000) Jamming transition of pedestrian traffic at crossing with open boundary conditions. *Physica A* 286:377-390
129. Muramatsu M, Irie T, Nagatani T (1999) Jamming transition in pedestrian counter flow. *Physica A* 267:487-498
130. Argebau (2005) *MVStättV – Erläuterungen: Musterverordnung über den Bau und Betrieb von Versammlungsstätten*. Erläuterungen, Juni 2005
131. Nagai R, Nagatani T (2006) Jamming transition in counter flow of slender particles on square lattice. *Physica A* 366:503
132. Nagai R, Fukamachi M, Nagatani T (2006) Evacuation of crawlers and walkers from corridor through an exit. *Physica A* 367:449-460
133. Nagel K, Schreckenberg M (1992) A cellular automaton model for freeway traffic. *J Phys I* 2:2221
134. Nakayama A, Hasebe K, Sugiyama Y (2005) Instability of pedestrian flow and phase structure in a two-dimensional optimal velocity model. *Phys Rev E* 71:036121
135. Navin PD, Wheeler RJ (1969) Pedestrian flow characteristics. *Traffic Eng* 39:31-36
136. Nelson HE, Mowrer FW (2002) Emergency movement. In: Di-Nenno PJ (ed) *SFPE Handbook of Fire Protection Engineering*, 3rd edn. National Fire Protection Association, Bethesda, p 367
137. National Fire Protection Association (2007) *NFPA 130: Standard for Fixed Guideway Transit and Passenger Rail Systems*.
138. Norwegian Ministry of Justice and Police (2000) *The High-Speed Craft MS Sleipner Disaster, 26 November 1999*. Official Norwegian Reports 2000:31, Oslo
139. Oeding D (1963) *Verkehrsbelastung und Dimensionierung von Gehwegen und anderen Anlagen des Fußgängerverkehrs*. Forschungsbericht, vol 22. Technische Hochschule Braunschweig
140. O'Flaherty CA, Parkinson MH (1972) Movement in a city centre footway. *Traffic Eng Control*, p 434
141. Okazaki S, Matsushita S (1993) A study of simulation model for pedestrian movement with evacuation and queuing. In: Smith RA, Dickie JF (eds) *Proceedings International Con-*



- ference Engineering Crowd Safety. Elsevier, Amsterdam, pp 271
142. Older SJ (1968) Movement of pedestrians on footways in shopping streets. *Traffic Eng Control* 10:160–163
  143. Owen M, Galea ER, Lawrence PJ, Filippidis L (1998) AASK – aircraft accident statistics and knowledge: a database of human experience in evacuation, derived from aviation accident reports. *Aero J* 102:353–363
  144. Pauls JL (1971) Evacuation drill held in the b. c. hydro building, 26 June 1969. Building Research Note 80, National Republican Congressional Committee
  145. Pauls JL (1995) Movement of people. In: DiNenno PJ, Beyler CL, Custer RLP, Walton WD, Watts JM, Drysdale D, Hall JR (eds) *SFPE Handbook of Fire Protection Engineering*, 2nd edn. National Fire Protection Association, Quincy, p 263
  146. Pauls JL, Fruin JJ, Zupan JM (2007) Minimum stair width for evacuation, overtaking movement and counterflow – technical bases and suggestions for the past, present and future. In: Waldau N, Gattermann P, Knoflacher H, Schreckenberg M (eds) *Pedestrian and Evacuation Dynamics 2005*. Springer, Berlin, pp 57–69
  147. Paulsen T, Soma H, Schneider V, Wiklund J, Lovas G (1995) Evaluation of simulation models of evacuating from complex spaces. SINTEF Report STF75 A95020. SINTEF, Trondheim
  148. Polus A, Joseph JL, Ushpiz A (1983) Pedestrian flow and level of service. *J Transp Eng* 109(1):46–56
  149. Popkov V, Schütz G (1999) Steady-state selection in driven diffusive systems with open boundaries. *Europhys Lett* 48:257
  150. Predtechenskii VM, Milinskii AI (1969) *Planing for foot traffic flow in buildings*. Amerind Publishing, New Dehli, 1978. Translation of: Proektirovanie Zhdaniis Uchetom Organizatsii Dvizheniya Lyudskikh Potokov, Stroiizdat Publishers, Moscow
  151. Predtetschenski WM, Milinski AI (1971) *Personenströme in Gebäuden – Berechnungsmethoden für die Modellierung*. Müller, Köln-Braunsfeld
  152. Predtetschenski WM, Cholstschewnikow WW, Völkel H (1972) Vereinfachte Berechnung der Umformung von Personenströmen auf Wegabschnitten mit begrenzter Länge. *Unser Brandschutz Wissenschaftlich-Technische Beil* 6:90–94
  153. Purser DA, Bensilium M (2001) Quantification of behaviour for engineering design standards and escape time calculations. *Saf Sci* 38(2):158–182
  154. Pushkarev B, Zupan JM (1975) Capacity of walkways. *Transp Res Rec* 538:1–15
  155. Quarantelli EL (1960) Images of withdrawal behavior in disasters: Some basic misconceptions. *Soc Probl* 8:63–79
  156. Quarantelli EL (2001) The sociology of panic. In: Smelser NJ, Baltes PB (eds) *International Encyclopedia of the Social and Behavioral Sciences*. Pergamon, New York, pp 11020–11030
  157. Revi A, Singh AK (2007) Cyclone and storm surge, pedestrian evacuation and emergency response in India. In: Waldau N, Gattermann P, Knoflacher H, Schreckenberg M (eds) *Pedestrian and Evacuation Dynamics 2005*. Springer, Berlin, pp 119–130
  158. Rex M, Löwen H (2007) Lane formation in oppositely charged colloids driven by an electric field: Chaining and two-dimensional crystallization. *Phys Rev E* 75:051402
  159. Rickert M, Nagel K, Schreckenberg M, Latour A (1996) Two lane traffic simulations using cellular automata. *Physica A* 231:534
  160. Rogsch C (2005) Vergleichende Untersuchungen zur dynamischen Simulation von Personenströmen. Technical report JUEL-4185. Forschungszentrum Jülich
  161. Rogsch C, Klingsch W, Seyfried A, Weigel H (2007) How reliable are commercial software-tools for evacuation calculation? In: *Interflam 2007 – Conference Proceedings*. Interscience Communication Ltd, Greenwich, London, pp 235–245
  162. Rogsch C, Klingsch W, Seyfried A, Weigel H (2007) Prediction accuracy of evacuation times for high-rise buildings and simple geometries by using different software-tools. In *Traffic and Granular Flow 2007*. Preprint
  163. Roitman MJ (1966) *Die Evakuierung von Menschen aus Bauwerken*. Staatsverlag der Deutschen Demokratischen Republik
  164. Rothman DH, Zaleski S (1994) Lattice-gas models of phase separation: Interfaces, phase transitions, and multiphase flow. *Rev Mod Phys* 66:1417
  165. Rothman DH, Zaleski S (1997) *Lattice-Gas Cellular Automata*. Cambridge University Press, Cambridge
  166. Saloma C, Perez GJ (2007) Herding in real escape panic. In: Waldau N, Gattermann P, Knoflacher H, Schreckenberg M (eds) *Pedestrian and Evacuation Dynamics 2005*. Springer, Berlin, pp 471–479
  167. Schadschneider A (2002) Cellular automaton approach to pedestrian dynamics – theory. In: Schreckenberg M, Sharma SD (eds) *Pedestrian and Evacuation Dynamics*. Springer, Berlin, pp 75–86
  168. Schelajew J, Schelajewa E, Semjonow N (2000) Nikolaus II. Der letzte russische Zar. Bechtermünz, Augsburg
  169. Schneider U, Kath K, Oswald M, Kirchberger H (2006) *Evakuierung und Verhalten von Personen im Brandfall unter spezieller Berücksichtigung von schienengebundenen Fahrzeugen*. Technical report 12, TU Wien
  170. Schreckenberg M, Sharma SD (eds) (2007) *Pedestrian and Evacuation Dynamics*. Springer, Berlin
  171. Schultz M, Lehmann S, Fricke H (2007) A discrete microscopic model for pedestrian dynamics to manage emergency situations in airport terminals. In: Waldau N, Gattermann P, Knoflacher H, Schreckenberg M (eds) *Pedestrian and Evacuation Dynamics 2005*. Springer, Berlin, pp 389–395
  172. Schütz GM (2001) Exactly solvable models for many-body systems. In: Domb C, Lebowitz JL (eds) *Phase Transitions and Critical Phenomena*, vol 19. Academic Press, Amsterdam
  173. Seeger PG, John R (1978) Untersuchung der Räumungsabläufe in Gebäuden als Grundlage für die Ausbildung von Rettungswegen, Teil III: Reale Räumungsversuche. Technical report T395. Forschungsstelle für Brandschutztechnik an der Universität Karlsruhe (TH)
  174. Seyfried A, Steffen B, Klingsch W, Boltes M (2005) The fundamental diagram of pedestrian movement revisited. *J Stat Mech* P10002
  175. Seyfried A, Steffen B, Lippert T (2006) Basics of modelling the pedestrian flow. *Physica A* 368:232–238
  176. Seyfried A, Rupperecht T, Passon O, Steffen B, Klingsch W, Boltes M (2007) Capacity estimation for emergency exits and bottlenecks. In: *Interflam 2007 – Conference Proceedings*. Interscience Communication Ltd, Greenwich, London
  177. Shestopal VO, Grubits SJ (1994) Evacuation model for merg-

- ing traffic flows in multi-room and multi-storey buildings. In: Kashiwagi T (ed) *Fire Safety Science – 4th international Symposium Proceedings*. Interscience, West Yard House, Guildford. The International Association for Fire Safety Science. Grove, London, pp 625–632
178. Sime JD (1990) *The Concept of Panic*. In: Canter D (ed) *Fires and Human Behaviour*, vol 1. Wiley, London, pp 63–81
  179. Smelser NJ (1962) *Theory of Collective Behavior*. Free Press, New York
  180. Still KG (2001) *Crowd Dynamics*, Ph.D. thesis, University of Warwick
  181. Tajima Y, Nagatani T (2002) Clogging transition of pedestrian flow in t-shaped channel. *Physica A* 303:239–250
  182. Taylor PM (1990) *The Hillsborough Stadium Disaster: Inquiry Final Report*. Technical report, Great Britain Home Office
  183. Templer J (1992) *The Staircase*. MIT Press, Cambridge
  184. Thompson PA, Marchant EW (1994) Simulex; developing new computer modelling techniques for evaluation. In: Kashiwagi T (ed) *Fire Safety Science – 4th international Symposium Proceedings*. Interscience, West Yard House, Guildford. The International Association for Fire Safety Science. Grove, London, pp 613–624
  185. Togawa K (1955) Study on fire escapes basing on the observation of multitude currents. Report of the building research institute. Ministry of Construction, Japan (in Japanese)
  186. Tsuji Y (2003) Numerical simulation of pedestrian flow at high densities. In: Galea ER (ed) *Pedestrian and Evacuation Dynamics 2003*. CMS Press, London, p 27
  187. Tubbs JS, Meacham B (2007) *Egress Design Solutions – A Guide to Evacuation and Crowd Management Planning*. Wiley, New Jersey
  188. Virkler MR, Elayadath S (1994) Pedestrian density characteristics and shockwaves. In: Akcelik R (ed) *Proceedings of the Second International Symposium on Highway Capacity*, vol 2. Australian Road Research Board, Sydney, pp 671–684
  189. Waldau N (2002) *Massenpanik in Gebäuden*. Diploma thesis, Technische Universität Wien
  190. Waldau N, Gattermann P, Knoflacher H, Schreckenberg M (eds) (2006) *Pedestrian and Evacuation Dynamics 2005*. Springer, Berlin
  191. Weckman LS, Mannikkö S (1999) Evacuation of a theatre: Exercise vs calculations. *Fire Mater* 23:357–361
  192. Weidmann U (1993) *Transporttechnik der Fußgänger – Transporttechnische Eigenschaften des Fußgängerverkehrs (Literaturauswertung)*. Schriftenreihe des IVT 90, ETH Zürich, 3 1993. Zweite, ergänzte Auflage (in German)
  193. Weifeng F, Lizhong Y, Weicheng F (2003) Simulation of bi-directional pedestrian movement using a cellular automata model. *Physica A* 321:633–640
  194. Wolf DE, Grassberger P (eds) (1996) *Friction, Arching, Contact Dynamics*. World Scientific, Singapore
  195. Yamamoto K, Kokubo S, Nishinari K (2006) New approach for pedestrian dynamics by real-coded cellular automata (rca). In: El Yacoubi S, Chopard B, Bandini S (eds) *Cellular Automata – 7th International Conference on Cellular Automata for Research and Industry, ACRI 2006, Perpignan*. Springer, Berlin, pp 728–731
  196. Yamamoto K, Kokubo S, Nishinari K (2007) Simulation for pedestrian dynamics by real-coded cellular automata (rca). *Physica A* 379:654
  197. Yamori K (1998) Going with the flow: Micro-macro dynamics in the macrobehavioral patterns of pedestrian crowds. *Psychol Rev* 105(3):530–557

### Books and Reviews

- Chopard B, Droz M (1998) *Cellular automaton modeling of physical systems*. Cambridge University Press, Cambridge
- Chowdhury D, Nishinari K, Santen L, Schadschneider A (2008) *Stochastic transport in complex systems: From molecules to vehicles*. Elsevier, Amsterdam
- DiNenno PJ (ed) (2002) *SFPE Handbook of Fire Protection Engineering*. National Fire Protection Association, Quincy
- Galea ER (ed) (2003) *Pedestrian and Evacuation Dynamics '03*. CMS Press, London
- Ped-Net collaboration. Webpage [www.ped-net.org](http://www.ped-net.org) (including discussion forum)
- Predtechenskii VM, Milinskii AI (1978) *Planing for foot traffic flow in buildings*. Amerint Publishing, New Delhi
- Schadschneider A, Pöschel T, Kühne R, Schreckenberg M, Wolf DE (eds) (2007) *Traffic and Granular Flow '05*. Springer, Berlin (see also previous issues of this conference series)
- Tubbs JS, Meacham BJ (2007) *Egress Design Solution – A Guide to Evacuation and Crowd Management Planning*. Wiley, New Jersey
- Waldau N, Gattermann P, Knoflacher H, Schreckenberg M (eds) (2007) *Pedestrian and Evacuation Dynamics '05*. Springer, Berlin